

**ESSEX COUNTY COUNCIL**

**PUBLIC PATH DIVERSION ORDER 2024  
FOOTPATH 7 CHELMSFORD GARDEN**

**IN  
THE CITY OF CHELMSFORD**

**TOWN & COUNTRY PLANNING ACT 1990 - SECTION 257  
PUBLIC PATH DIVERSION ORDER**

**ESSEX COUNTY COUNCIL**

**TOWN & COUNTRY PLANNING ACT 1990 - SECTION 257**

**PUBLIC PATH DIVERSION ORDER**

**FOOTPATH 7 CHELMSFORD GARDEN**

This Order is made by Essex County Council (“the authority”) under section 257 of the Town & Country Planning Act 1990 (“the 1990 Act”) because it is satisfied that it is necessary to divert part of the footpath to which this order relates in order to enable development to be carried out in accordance with planning permission granted under Part III of the Town and Country Planning Act 1990 by Essex County Council namely: planning reference CC/CHL/85/21 for Chelmsford North East Bypass (CNEB): A single carriageway road between Roundabout 4 of the Beaulieu Park Radial Distributor Road (RDR1) and a new roundabout on the A131 at Chatham Green plus dualling of the existing A131 between Chatham Green and Deres Bridge roundabout. With one intermediate roundabout, 3 road overbridges and 1 pedestrian/cycle/horse overbridge. Together with other associated works and landscaping at Land between Beaulieu Park (north of Generals Lane) Boreham Parish and Deres Bridge Roundabout on A131 Great & Little Leighs Parish to the northeast of Chelmsford.

**BY THIS ORDER:**

1. The footpath over the land situated north west of Mount Maskall Chelmsford Garden known as Footpath 7 Chelmsford Garden in the City of Chelmsford and shown by a bold continuous black line on the attached Order Map numbered PROW-23-37 rev.06.02.24 and described in Part 1 of the Schedule to this Order (“the Schedule”) shall be diverted as provided below.
2. There shall be created to the reasonable satisfaction of the authority an alternative highway for use as a replacement for the said footpath as provided in Part 2 of the Schedule and shown by a bold black dashed line on the attached map.
3. The diversion of the footpath shall have effect on the date on which the authority certify that the terms of Article 2 above have been complied with.

**DIVERSION OF FOOTPATH 7 CHELMSFORD GARDEN  
CITY OF CHELMSFORD  
SECTION 257 TOWN & COUNTRY PLANNING ACT 1990**

Plan No. PROW-23-37 rev.06.02.24  
Key:

- Route to Close A--B-C
- New Routes A-D-E
- Unaffected Routes
- Chelmsford North East Bypass approx. route

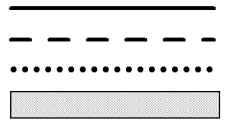

Definitive Map Sheet TL71SW  
Scale 1: 2,500 (A3)  
Grid Reference at A 57380,21119  
Postcode at A CM3 3HW

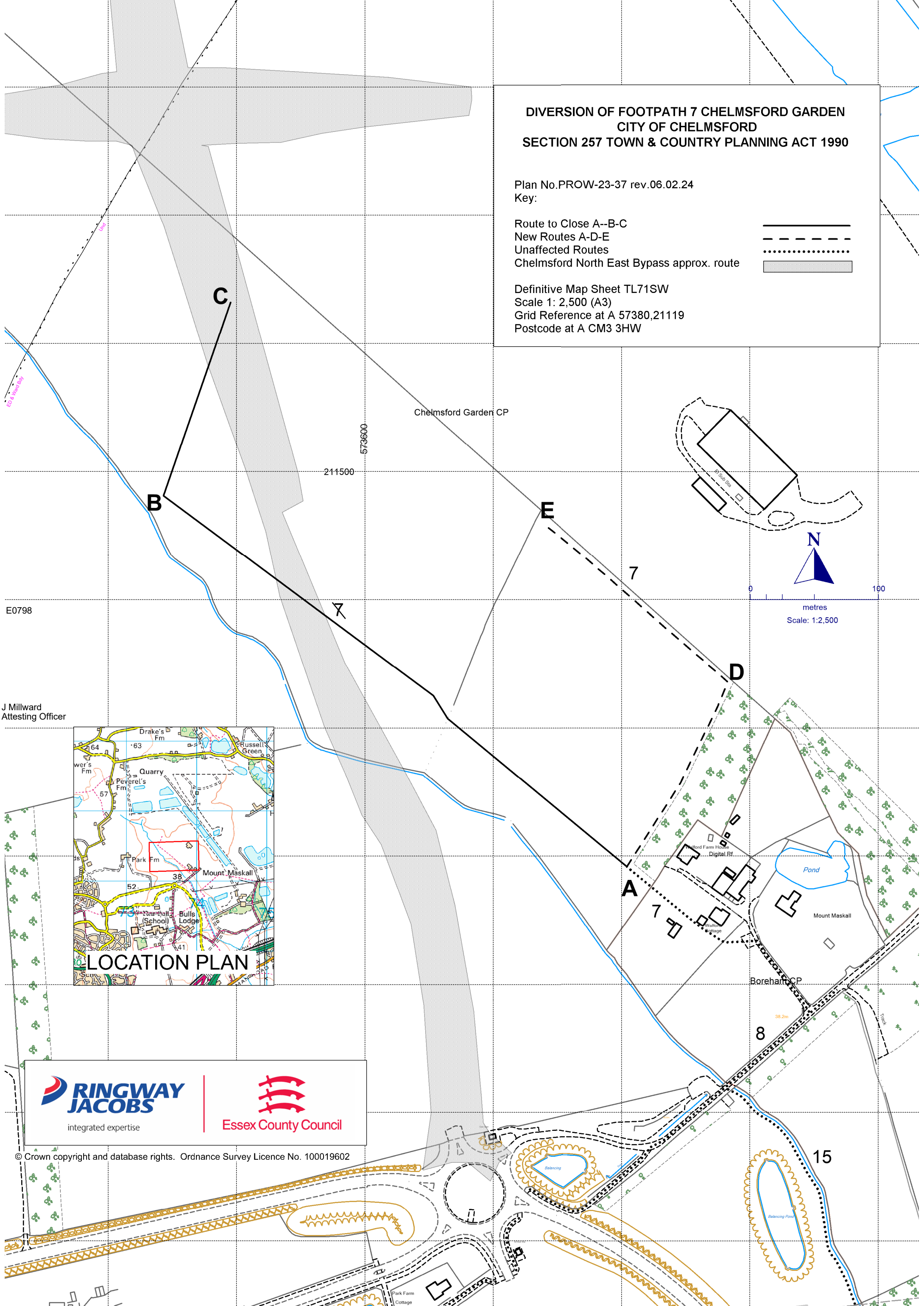

J Millward  
Attesting Officer

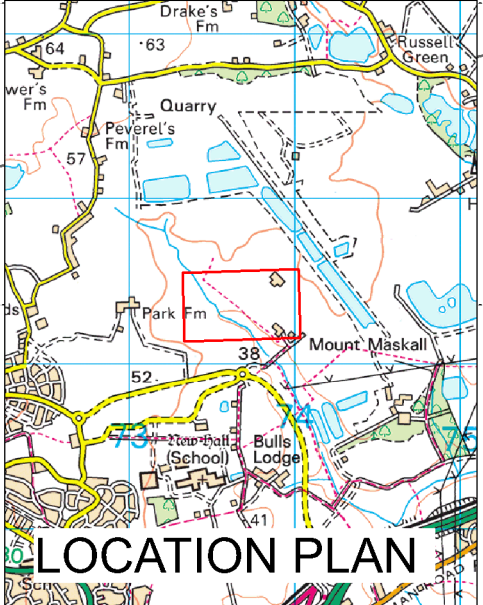



integrated expertise



Essex County Council

© Crown copyright and database rights. Ordnance Survey Licence No. 100019602

4. The following works shall be carried out in relation to the highways described in Part 2 of the Schedule:

- a) The proposed footpath shall comprise a clear level surface of 2 metres in width
- b) The proposed new route shall be signed where appropriate with way-markers in order to show the direction and route of the path.

5. Essex County Council Infrastructure Projects Capital Delivery Infrastructure & Environment team (“the applicant”) are hereby required to pay the full costs of seeking the diversion Order; this to include costs of advertising and administration accommodation costs for any resulting hearing or inquiry and the removal or abandonment of any apparatus including the cost of providing any telecom apparatus rendered useless under in on over along or across the path to be stopped up.

6. Where immediately before the date on which part of the footpath is diverted there is apparatus under in on over along or across it belonging to statutory undertakers for the purpose of carrying out their undertaking the undertakers shall continue to have the same rights in respect of the apparatus as they then had.

## SCHEDULE

### [PART 1]

#### DESCRIPTION OF SITE OF EXISTING PATH OR WAY

A part length of Footpath 7 Chelmsford Garden shown by a bold black continuous line on the Order Map starting from point **A** at grid reference 57380,21119 at the south west corner of a wooded area running in a north westerly direction across a field for a distance of approximately 463 metres to point **B** at grid reference 57344,21148 at a point located approximately 18 metres north of the nearest field edge then continuing in a north north easterly direction for a final distance of approximately 159 metres to point **C** at grid reference 57349,21163 where it terminates approximately 38 metres south of the nearest field edge.

### [PART 2]

#### DESCRIPTION OF SITE OF NEW PATH OR WAY

A Footpath being 2 metres in width shown by a bold black dashed line on the Order Map commencing at the aforementioned point **A** running in a north north easterly direction along a field edge north west of a wooded area for a distance of approximately 164 metres to point **D** at grid reference 57388,21133 located in the north east corner of the field then continuing in a north westerly direction along the field edge for a final distance of approximately 189 metres to point **E** at grid reference 57373,21145 at the north west corner of the field where it terminates.

The COMMON SEAL of ESSEX COUNTY COUNCIL was hereunto affixed on the  
eighteenth day of April 2024.

E0798

in the presence of

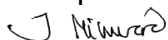

Jacqueline Millward  
Attesting Officer

Dated: 18th April 2024

**PUBLIC PATH DIVERSION ORDER**

**TOWN & COUNTRY PLANNING  
ACT 1990 SECTION 257**

Footpath 7 Chelmsford Garden  
City of Chelmsford

Paul Turner  
Director, Legal and Assurance

Seax House  
Victoria Road South  
Chelmsford  
Essex  
CM1 1QH