

ESSEX COUNTY COUNCIL

PUBLIC PATH DIVERSION ORDER 2023

FOOTPATH 2 FINCHINGFIELD

IN THE DISTRICT OF BRAINTREE

HIGHWAYS ACT 1980 - SECTION 119

PUBLIC PATH DIVERSION ORDER

PUBLIC PATH DIVERSION ORDER
HIGHWAYS ACT 1980 – SECTION 119
ESSEX COUNTY COUNCIL
FOOTPATH 2 FINCHINGFIELD

This Order is made by Essex County Council (“the authority”) under section 119 of the Highways Act 1980 (“the 1980 Act”) because it appears to the authority that in the interest of the owner of the land crossed by the footpath described in paragraph 1 of this order it is expedient that the line of the path should be diverted.

The landowner has agreed to defray any compensation which becomes payable in consequence of the coming into force of this order and any expenses incurred in the order making and bringing the new site of the path into a fit condition for use by the public.

Braintree District Council have been consulted as required by section 120(2) of the 1980 Act.

BY THIS ORDER:

- 1) The public right of way over the land situated in the area of Locksmith’s Farm Robinhood End in Finchingfield known as Footpath 2 Finchingfield in the District of Braintree and shown by a bold continuous line on the order map numbered PROW-22-25 rev.25.08.23 contained in this order and described in Part 1 of the Schedule to this order shall be stopped up after 35 days from the date of confirmation of this order.
- 2) There shall at the end of 28 days from the date of confirmation of this order be a public footpath over land situated in the area of Locksmith’s Farm Robinhood End in Finchingfield known as Footpath 2 Finchingfield in the District of Braintree as described in Part 2 of the Schedule and shown by a bold broken line on the order map numbered PROW-22-25 rev.25.08.23 contained in this order.
- 3) The rights conferred on the public under this order shall be subject to the limitations and conditions set out in Part 3 of the Schedule.

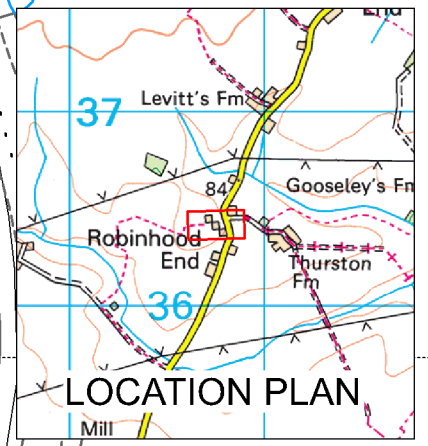
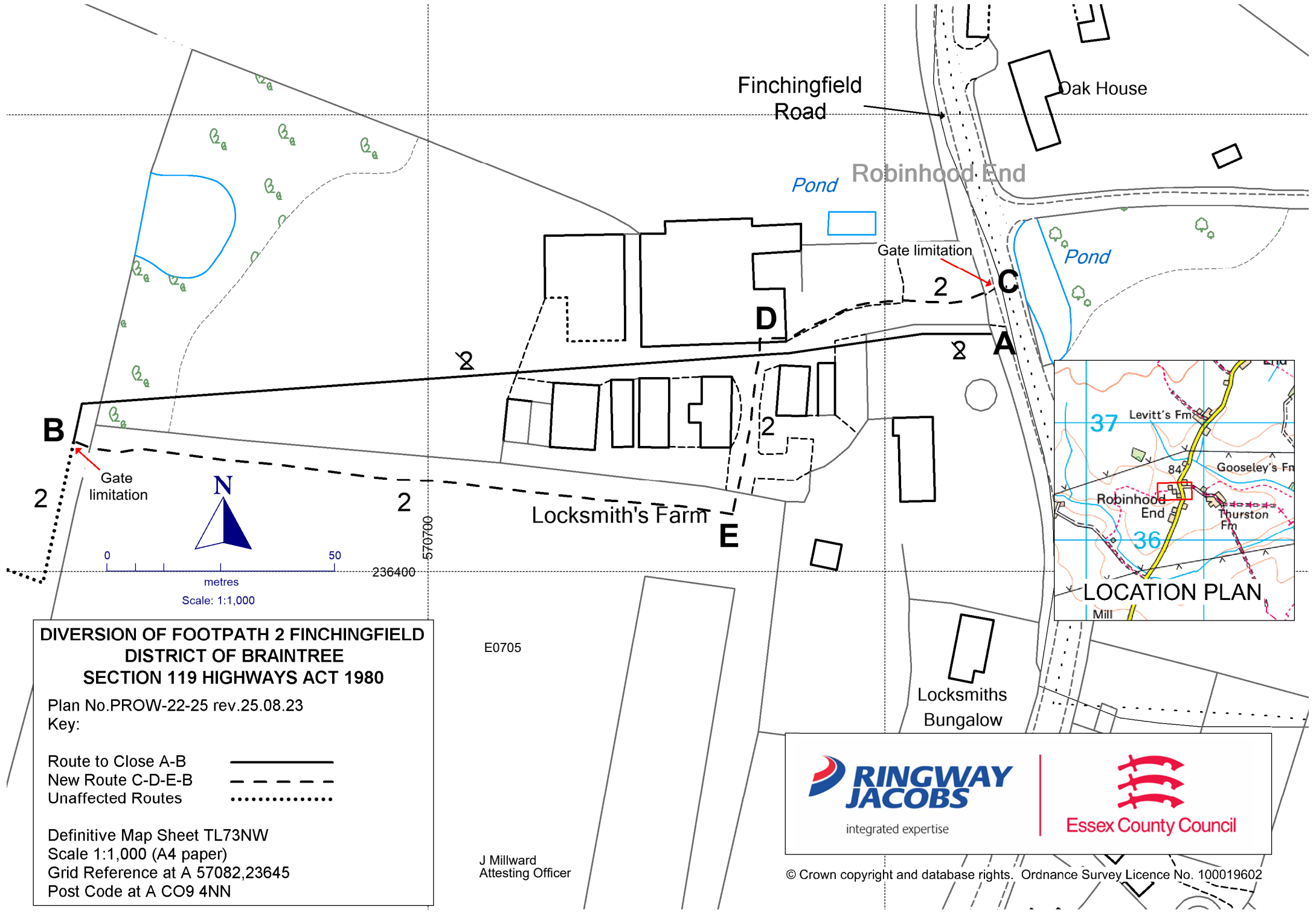

DIVERSION OF FOOTPATH 2 FINCHINGFIELD DISTRICT OF BRAINTREE SECTION 119 HIGHWAYS ACT 1980

Plan No. PROW-22-25 rev.25.08.23

Key:

Route to Close A-B —————

New Route C-D-E-B - - - - -

Unaffected Routes ·······

Definitive Map Sheet TL73NW
 Scale 1:1,000 (A4 paper)
 Grid Reference at A 57082,23645
 Post Code at A CO9 4NN

E0705

J Millward
 Attesting Officer



integrated expertise



Essex County Council

SCHEDULE

(PART 1)

DESCRIPTION OF SITE OF EXISTING PATH OR WAY

A part length of Footpath 2 Finchingfield of unknown width shown by a bold continuous line on the order map commencing from point **A** at grid reference 57082,23645 where it connects to Finchingfield Road running in a west south westerly direction along the southern side of an access drive between farm buildings for a total distance of approximately 207 metres to point **B** at grid reference 57062,23642 where it continues unaffected.

(PART 2)

DESCRIPTION OF SITE OF NEW PATH OR WAY

A footpath being 2 metres in width shown by a bold broken line on the order map commencing at point **C** at grid reference 57082,23646 where it connects to Finchingfield Road approximately 10 metres north of the aforementioned point **A** running in a west south westerly direction north of an access drive for a distance of approximately 50 metres to point **D** at grid reference 57077,23645 then running in a generally southerly direction between farm buildings for a further distance of approximately 38 metres to point **E** at grid reference 57076,23641 at the north east corner of a field then continuing in a west north westerly direction along the northern edge of a field south of a ditch line for a final distance of approximately 145 metres to the aforementioned point **B** where it continues unaffected.

[PART 3]

LIMITATIONS AND CONDITIONS

<p>1. At the point marked C on the order map (PROW-22-25 rev.25.08.23) (grid reference 57082,23646)</p>	<p>The right of the landowner to install and maintain a pedestrian gate subject to its removal should the limitation become unnecessary whereby an available width shall remain of 2 metres, this being the dedicated width of the path as specified in Part 2 of the Schedule</p>
<p>2. At the point marked B on the order map (PROW-22-25 rev.25.08.23) (grid reference 57062,23642)</p>	<p>The right of the landowner to install and maintain a pedestrian gate subject to its removal should the limitation become unnecessary whereby an available width shall remain of 2 metres, this being the dedicated width of the path as specified in Part 2 of the Schedule</p>

The COMMON SEAL of ESSEX COUNTY COUNCIL was hereunto affixed on the Twenty Eighth day of September 2023

E0705

In the presence of
Jacqueline Millward
Attesting Officer

Dated: 28th day of September 2023

PUBLIC PATH DIVERSION ORDER

**HIGHWAYS ACT 1980
SECTION 119**

Footpath 2 Finchingfield
in the District of Braintree

Paul Turner
Director, Legal and Assurance

Seax House
Victoria Road South
Chelmsford
Essex
CM1 1QH