

ESSEX COUNTY COUNCIL

PUBLIC PATH DIVERSION ORDER 2023

BRIDLEWAY 47 RADWINTER

IN THE DISTRICT OF UTTLESFORD

HIGHWAYS ACT 1980 - SECTION 119

PUBLIC PATH DIVERSION ORDER

PUBLIC PATH DIVERSION ORDER
HIGHWAYS ACT 1980 – SECTION 119
ESSEX COUNTY COUNCIL
BRIDLEWAY 47 RADWINTER

This Order is made by Essex County Council (“the authority”) under section 119 of the Highways Act 1980 (“the 1980 Act”) because it appears to the authority that in the interest of the owner of the land crossed by the bridleway described in paragraph 1 of this order it is expedient that the line of the way should be diverted.

The applicant has agreed to defray any compensation which becomes payable in consequence of the coming into force of this order and to defray any expenses incurred in the order making and bringing the new site of the way into a fit condition for use by the public.

Uttlesford District Council have been consulted.

BY THIS ORDER:

- 1) The public right of way over the land situated south and east of Stocking Green Farm known as Bridleway 4 Radwinter in the District of Uttlesford and shown by a bold continuous line on the order map numbered PROW-21-30 rev.26.07.22 contained in this order and described in Part 1 of the Schedule to this order shall be stopped up after 35 days from the date of confirmation of this order.

- 2) There shall at the end of 28 days from the date of confirmation of this order be a public bridleway over land situated south and east of Stocking Green Farm known as Bridleway 4 Radwinter in the District of Uttlesford as described in Part 2 of the Schedule and shown by a bold broken line on the order map numbered PROW-21-30 rev.26.07.22 contained in this order.

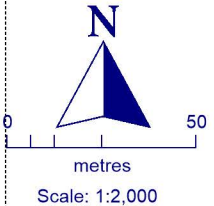
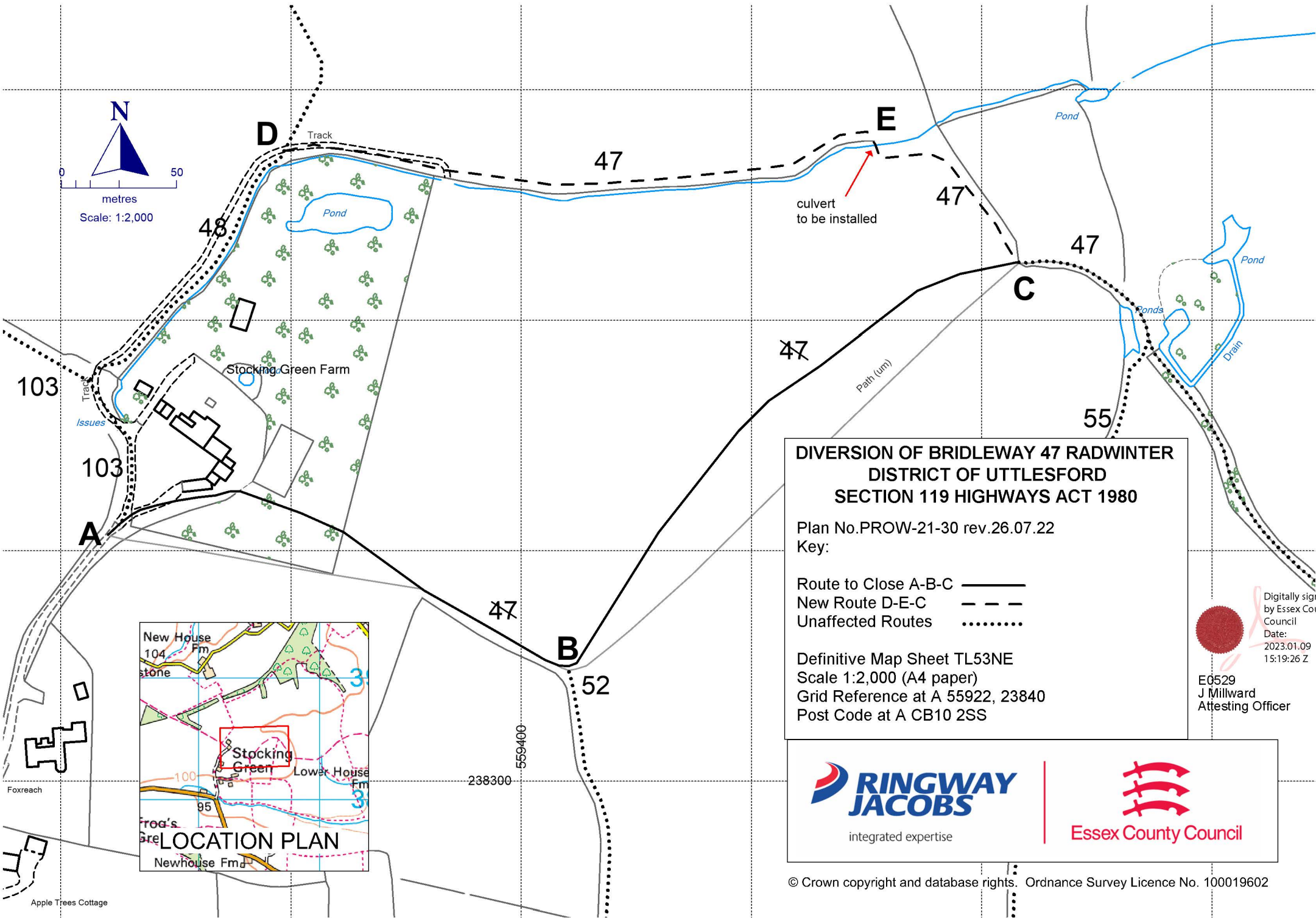

**DIVERSION OF BRIDLEWAY 47 RADWINTER
DISTRICT OF UTTLESFORD
SECTION 119 HIGHWAYS ACT 1980**

Plan No. PROW-21-30 rev.26.07.22

Key:

- Route to Close A-B-C ———
- New Route D-E-C - - - - -
- Unaffected Routes

Definitive Map Sheet TL53NE
Scale 1:2,000 (A4 paper)
Grid Reference at A 55922, 23840
Post Code at A CB10 2SS

Digitally signed
by Essex County
Council
Date:
2023.01.09
15:19:26 Z

E0529
J Millward
Attesting Officer



SCHEDULE

(PART 1)

DESCRIPTION OF SITE OF EXISTING WAY

A part length of Bridleway 47 Radwinter of unknown width shown by a bold continuous line on the order map commencing from point **A** at grid reference 55922,23840 where it connects to Bridleway 103 Radwinter and the unnamed road to Stocking Green Farm running in an east north easterly then south easterly direction along a driveway through a garden continuing across a small section of field and along a field edge for a distance of approximately 224 metres to point **B** at grid reference 55942,23835 where it connects to Footpath 52. The way then continues in a north easterly direction across a field for a final distance of approximately 270 metres to point **C** at grid reference 55961,23852 at the corner of a headland where it continues unaffected.

(PART 2)

DESCRIPTION OF SITE OF NEW WAY

A bridleway being 3 metres in width shown by a bold broken line on the order map commencing at point **D** at grid reference 55929,23857 just north of the north western boundary of Stocking Green Farm where it connects to Footpath 48 Radwinter running west along the field edge on the northern side of a field boundary for a distance of approximately 258 metres to point **E** at grid reference 55955,23858 then continuing first in a southerly then westerly then south westerly direction crossing the ditch by a culvert and then along the field edge for a final distance of approximately 96 metres to the aforementioned point **C** where it continues unaffected.

The COMMON SEAL of the ESSEX COUNTY COUNCIL was hereunto affixed on the Ninth day of January 2023

E0529

In the presence of
Jacqueline Millward
Attesting Officer



Digitally signed
by Essex
County Council
Date:
2023.01.09
15:20:13 Z

Dated: 9th day of January 2023

PUBLIC PATH DIVERSION ORDER

**HIGHWAYS ACT 1980
SECTION 119**

Bridleway 47 Radwinter in the District of
Uttlesford

Paul Turner
Director, Legal and Assurance

Seax House
Victoria Road South
Chelmsford
Essex
CM1 1QH

**HIGHWAYS ACT 1980
SECTION 119**

PUBLIC PATH DIVERSION ORDER 2023

BRIDLEWAY 47 RADWINTER

IN THE DISTRICT OF UTTLESFORD

ESSEX COUNTY COUNCIL in exercise of the powers conferred upon them in that behalf, hereby confirm the foregoing Order:

THIS ORDER IS HEREBY CONFIRMED AS UNOPPOSED ORDER

The COMMON SEAL of the ESSEX COUNTY COUNCIL was hereunto affixed on the Second day of November 2023

E0718

in the presence of
Jacqueline Millward
Attesting Officer

Dated: 2nd day of November 2023

CONFIRMATION ORDER

PUBLIC PATH DIVERSION ORDER

**HIGHWAYS ACT 1980
SECTION 119**

Bridleway 47 in Radwinter
in the District of Uttlesford

PAUL TURNER
Director, Legal and Assurance

Essex County Council
Seax House
Victoria Road South
Chelmsford
Essex
CM1 1QH