

**ESSEX COUNTY COUNCIL**

**PUBLIC PATH CREATION ORDER 2023**

**FOOTPATH CREATION AT STOCKING GREEN FARM IN RADWINTER  
IN THE DISTRICT OF UTTLESFORD**

**HIGHWAYS ACT 1980 - SECTION 26  
PUBLIC PATH CREATION ORDER**

**PUBLIC PATH CREATION ORDER**  
**HIGHWAYS ACT 1980 - SECTION 26**  
**ESSEX COUNTY COUNCIL**  
**FOOTPATH CREATION ON LAND AT STOCKING GREEN FARM**  
**IN RADWINTER**

This Order is made by Essex County Council (“the authority”) under section 26 of the Highways Act 1980 (“the 1980 Act”) because it appears to the authority that having regard to the matters set out in section 26(1) and that it is expedient that a section of path (between the current route of Bridleway 47 Radwinter and that bridleway’s connection with Footpath 52 Radwinter) should be created as a footpath on the grounds of preserving the footpath connection of Footpath 52 to the network of public rights of way and to replace the connection lost by the diversion of Bridleway 47 Radwinter for the convenience of the public.

Uttlesford District Council has been consulted as required by section 26(3) of the 1980 Act.

**BY THIS ORDER:**

1. There shall be at the end of 28 days from the confirmation of this Order there shall be a public footpath over the land situated at Stocking Green Farm in Radwinter as described in the Schedule to this order and shown by a bold broken line on the Order Map numbered PROW-22-32 contained in this Order.

2. The Council will set out the said footpath to a standard commensurate with it being a highway maintainable at the public expense within 28 days from the date of this Order. The construction of the footpath referred to in the Schedule to this order shall include the following:

- (i) a path of 2 metres in width between points A and B
- (ii) existing surfaces to be maintained
- (iii) a fingerpost at point A and a waymarker at point B



0 50  
metres  
Scale: 1:2,000

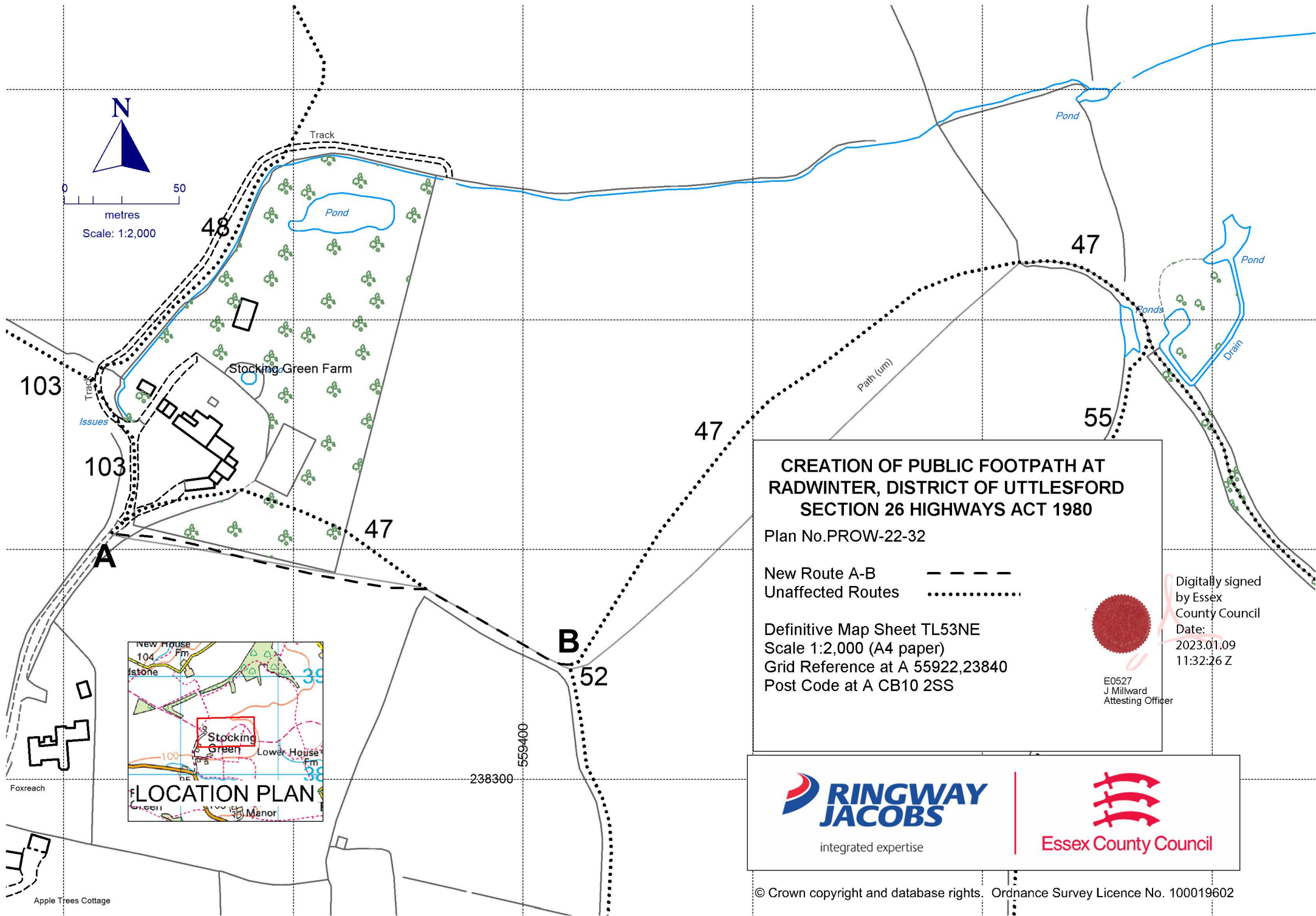

### CREATION OF PUBLIC FOOTPATH AT RADWINTER, DISTRICT OF UTTLESFORD SECTION 26 HIGHWAYS ACT 1980

Plan No. PROW-22-32

New Route A-B      - - - - -  
Unaffected Routes      ·········

Definitive Map Sheet TL53NE  
Scale 1:2,000 (A4 paper)  
Grid Reference at A 55922,23840  
Post Code at A CB10 2SS

  
Digitally signed  
by Essex  
County Council  
Date:  
2023.01.09  
11:32:26 Z  
E0527  
J Millward  
Attesting Officer



integrated expertise



Essex County Council

## SCHEDULE

### DESCRIPTION OF SITE OF NEW PATH

A length of footpath being 2 metres in width shown by a bold broken line on the Order Map commencing at point **A** at grid reference 55922,23840 where it meets Bridleway 103 Radwinter and the unnamed road to Stocking Green Farm running first in an east south easterly then south easterly direction along a field edge across a field then along a further field edge for a total distance of approximately 211 metres to point **B** at grid reference 55942,23835 where it connects to Footpath 52 Radwinter.

The COMMON SEAL of the ESSEX COUNTY COUNCIL was hereunto affixed on the Ninth day of January 2023

E0527

In the presence of  
Jacqueline Millward  
Attesting Officer

  
Digitally  
signed by  
Essex County  
Council  
Date:  
2023.01.09  
11:50:29 Z

Dated: 9th day of January 2023

## **PUBLIC PATH CREATION ORDER**

### **Highways Act 1980 Section 26**

Creation of a Footpath on land at  
Stocking Green Farm in Radwinter in the  
District of Uttlesford  
Linking Footpath 52 Radwinter with  
Bridleway 103 Radwinter and the  
unnamed highway to Stocking Green  
Farm.

Paul Turner  
Director, Legal & Assurance

Essex Legal Services  
Seax House  
Chelmsford  
Essex  
CM1 1QH

**HIGHWAYS ACT 1980  
SECTION 26**

**PUBLIC PATH CREATION ORDER 2023**

**FOOTPATH CREATION AT STOCKING GREEN FARM IN RADWINTER  
IN THE DISTRICT OF UTTLESFORD**

**ESSEX COUNTY COUNCIL** in exercise of the powers conferred upon them  
in that behalf, hereby confirm the foregoing Order:

THIS ORDER IS HEREBY CONFIRMED AS UNOPPOSED ORDER

The COMMON SEAL of the ESSEX COUNTY COUNCIL was hereunto affixed on  
the Second day of November 2023

E0716

in the presence of  
Jacqueline Millward  
Attesting Officer

Dated: 2nd day of November 2023

**CONFIRMATION ORDER**

**PUBLIC PATH CREATION ORDER**

**HIGHWAYS ACT 1980  
SECTION 26**

Creation of a Footpath on land at Stocking  
Green Farm in Radwinter in the District of  
Uttlesford.

Linking Footpath 52 Radwinter with Bridleway  
103 Radwinter and the unnamed highway to  
Stocking Green Farm

PAUL TURNER  
Director, Legal and Assurance

Essex County Council  
Seax House  
Victoria Road South  
Chelmsford  
Essex  
CM1 1QH