

Legal notice to the public

Public notice

**NOTICE OF MAKING OF AN ORDER
HIGHWAYS ACT 1980
ESSEX COUNTY COUNCIL
PUBLIC PATH DIVERSION ORDER 2021
FOOTPATH 36 CHELMSFORD**

The above order, made on 27 January 2021 under section 119 of the Highways Act 1980, will divert a part length of Footpath 36 Chelmsford of unknown width shown by a bold continuous line on the order map commencing from a point on the west side of Butts Way running in a west north westerly then south westerly direction between two property boundaries then continuing through a garden area for a total distance of 197 metres to the point where it connects to Footpath 35 Chelmsford on Private Road, to an alternative route 2 meters in width commencing from the aforementioned start point running in a south, south westerly direction for a distance of 107 metres along Butts Way to the point where it meets Footpath 35 Chelmsford on Private Road

Copies of the order and order map can be requested to be posted or viewed by emailing publicpathorders@essexhighways.org to arrange a suitable time to inspect the documents quoting the Order title. Documents can be made available for inspection 8.30am-4.30pm Mon-Fri at Essex County Council, County Hall, E block main reception, Market Road, Chelmsford if so required following the current social distancing restrictions. Copies of the order and order map are available on Essex Highways website at:

<https://www.essexhighways.org/transport-and-roads/getting-around/public-rights-of-way/public-path-notices.aspx> and have also been sent to Chelmsford City Council

Any representations about or objections to the order may be sent in writing to Robert Lee, Definitive Map Service, Essex County Council, Seax House, 2nd Floor, Victoria Road South, Chelmsford CM1 1QH not later than 11 March 2021. Please state the grounds on which they are made.

If no such representations or objections are duly made, or if any so made are withdrawn, Essex County Council may confirm the Order as an unopposed order. If the Order is sent to the Secretary of State for the Environment for confirmation any representations or objections which have not been withdrawn will be sent together with the Order. Any such representation or objections will be taken into account by the Council with the result that they may be made available to the public under the Local Government (Access to Information) Act 1985.

Dated 11 February 2021



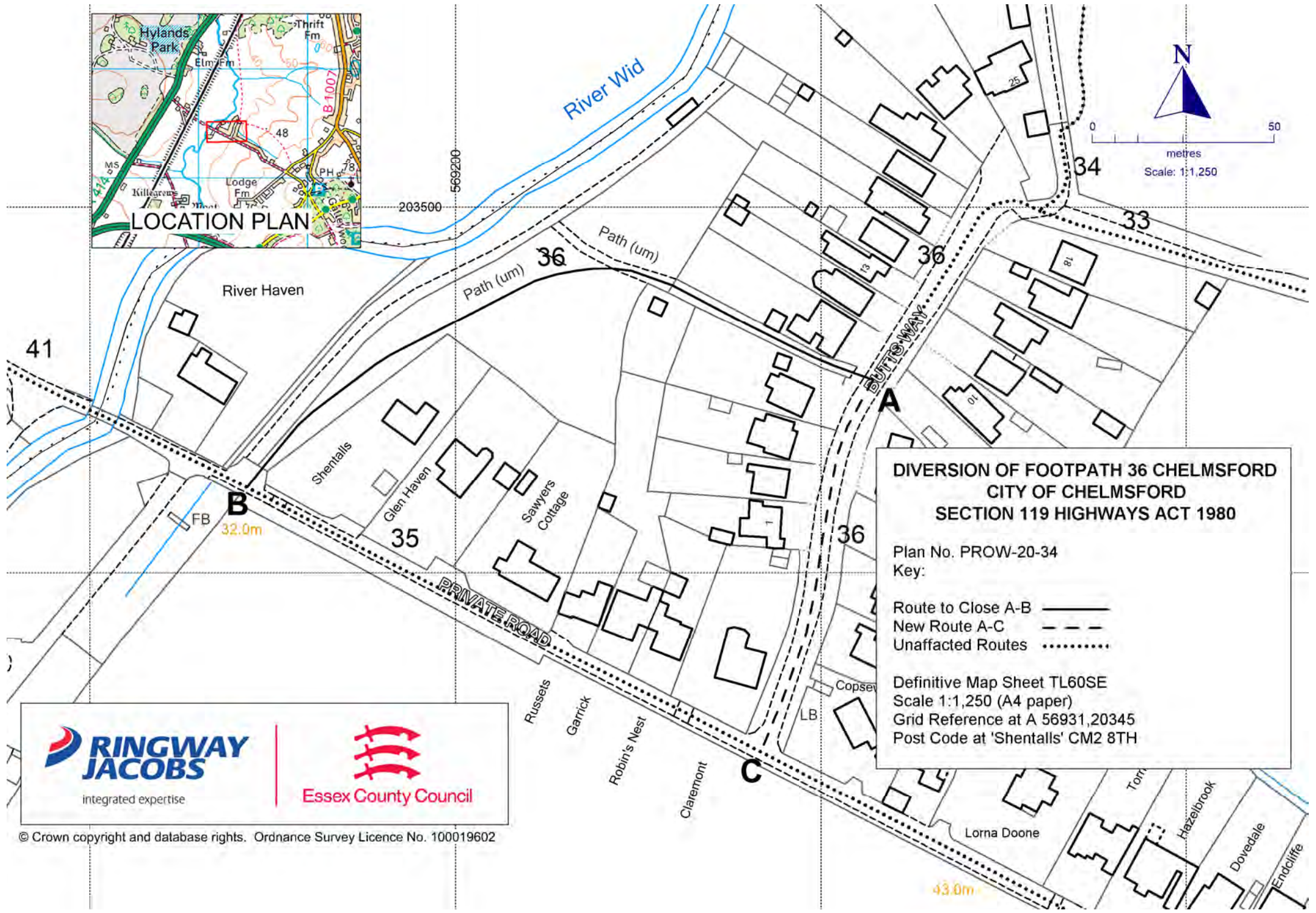
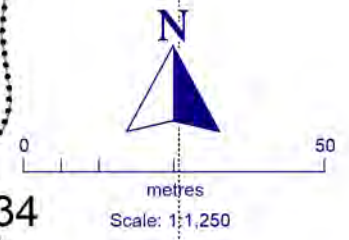

**DIVERSION OF FOOTPATH 36 CHELMSFORD
CITY OF CHELMSFORD
SECTION 119 HIGHWAYS ACT 1980**

Plan No. PROW-20-34
Key:

Route to Close A-B ———
New Route A-C - - -
Unaffected Routes
Definitive Map Sheet TL60SE
Scale 1:1,250 (A4 paper)
Grid Reference at A 56931,20345
Post Code at 'Shentalls' CM2 8TH

© Crown copyright and database rights. Ordnance Survey Licence No. 100019602

Public Notices

Public Notices

Essex County Council

**Notice of Making of An Order
Highways Act 1980
Public Path Diversion Order 2021
Footpath 8 Little Dunmow**

The above order, made on 27 January 2021 under section 119 of the Highways Act 1980, will divert a part length of Footpath 8 Little Dunmow of unknown width shown by a bold continuous line on the Order Map commencing from the garden boundary of Bouchiers Barn running in a south westerly direction across the garden for a total distance of 33 metres to the point where the path connects to Footpath 19 Little Dunmow and continues unaffected, to an alternative route 2 metres in width commencing from the aforementioned start point running in a south south easterly direction along the field edge for a total distance of 54 metres to a point at the end the garden boundary of Bouchiers Barn where it continues unaffected.

Copies of the order and order map can be requested to be posted or viewed by emailing publicpathorders@essexhighways.org to arrange a suitable time to inspect the documents quoting the Order title. Documents can be made available for inspection 8.30am-4.30pm Mon-Fri at Essex County Council, County Hall, E block main reception, Market Road, Chelmsford if so required following the current social distancing restrictions. Copies of the order and order map are available on Essex Highways website at:

<https://www.essexhighways.org/transport-and-roads/getting-around/public-rights-of-way/public-path-notices.aspx> and have also been sent to Little Dunmow Parish and Uttlesford District Councils

Any representations about or objections to the order may be sent in writing to Robert Lee, Definitive Map Service, Essex County Council, Seax House, 2nd Floor, Victoria Road South, Chelmsford CM1 1QH not later than 11 March 2021. Please state the grounds on which they are made.

If no such representations or objections are duly made, or if any so made are withdrawn, Essex County Council may confirm the Order as an unopposed order. If the Order is sent to the Secretary of State for the Environment for confirmation any representations or objections which have not been withdrawn will be sent together with the Order. Any such representation or objections will be taken into account by the Council with the result that they may be made available to the public under the Local Government (Access to Information) Act 1985.

**Notice of Making of An Order
Highways Act 1980
Public Path Diversion Order 2021
Footpath 36 Chelmsford**

The above order, made on 27 January 2021 under section 119 of the Highways Act 1980, will divert a part length of Footpath 36 Chelmsford of unknown width shown by a bold continuous line on the order map commencing from a point on the west side of Butts Way running in a west north westerly then south westerly direction between two property boundaries then continuing through a garden area for a total distance of 197 metres to the point where it connects to Footpath 35 Chelmsford on Private Road, to an alternative route 2 metres in width commencing from the aforementioned start point running in a south, south westerly direction for a distance of 107 metres along Butts Way to the point where it meets Footpath 35 Chelmsford on Private Road.

Copies of the order and order map can be requested to be posted or viewed by emailing publicpathorders@essexhighways.org to arrange a suitable time to inspect the documents quoting the Order title. Documents can be made available for inspection 8.30am-4.30pm Mon-Fri at Essex County Council, County Hall, E block main reception, Market Road, Chelmsford if so required following the current social distancing restrictions. Copies of the order and order map are available on Essex Highways website at:

<https://www.essexhighways.org/transport-and-roads/getting-around/public-rights-of-way/public-path-notices.aspx> and have also been sent to Chelmsford City Council

Any representations about or objections to the order may be sent in writing to Robert Lee, Definitive Map Service, Essex County Council, Seax House, 2nd Floor, Victoria Road South, Chelmsford CM1 1QH not later than 11 March 2021. Please state the grounds on which they are made.

If no such representations or objections are duly made, or if any so made are withdrawn, Essex County Council may confirm the Order as an unopposed order. If the Order is sent to the Secretary of State for the Environment for confirmation any representations or objections which have not been withdrawn will be sent together with the Order. Any such representation or objections will be taken into account by the Council with the result that they may be made available to the public under the Local Government (Access to Information) Act 1985.

(Church Road, Chelmsford) (Temporary Prohibition of Traffic) Order 2021
Notice is hereby given that the Essex County Council intends, not less than seven days from the date of this notice, to make the above Order under section 14(1) of the Road Traffic Regulation Act 1984.

Effect of the order: To temporarily close that length of Church Road, Chelmsford in the City of Chelmsford, from its junction with Carsey Close to its junction with Downham Road a distance of approximately 130m. The closure is scheduled to commence on 4th March 2021 for 2 days, or where stated on a valid permit (EP201EH2307912 – Essex County Council). The scheduled dates may vary for these works with appropriate signs showing and/or displayed on one.network. The closure is required for the safety of the public and workforce while carriageway patching works are undertaken by Essex County Council.

An alternative route is available via Church Road, London Road, London Road Roundabout, Golden Jubilee Way, Runwell Road Roundabout, Runwell Road, Swan Lane, Brock Hill, Sudbury Road, School Road, Downham Road and vice versa.

The Order will come into effect on 18th February 2021 and may continue in force for 18 months or until the works have been completed, whichever is the earlier.

(Mashbury Road, Chelmsford) (Temporary Prohibition of Traffic) Order 2021
Notice is hereby given that the Essex County Council intends, not less than seven days from the date of this notice, to make the above Order under section 14(1) of the Road Traffic Regulation Act 1984.

Effect of the order: To temporarily close that length of Mashbury Road, Chelmsford in the City of Chelmsford, from a point approximately 1790m west of its junction with Humphreys Farm Lane for a distance of approximately 70m in a westerly direction. The closure is scheduled to commence on 2nd March 2021 for 1 day, or where stated on a valid permit (BC00803MARWANK1E6N – BT). The scheduled dates may vary for these works with appropriate signs showing and/or displayed on one.network. The closure is required for the safety of the public and workforce while overhead structure works are undertaken by BT.

An alternative route is available via Mashbury Road, Barrack Lane, The Village, South Street, Breeds Road, Chignal Road, Fox Road and vice versa.

The Order will come into effect on 18th February 2021 and may continue in force for 18 months or until the works have been completed, whichever is the earlier.

(Mill Lane, Chelmsford) (Temporary Prohibition of Traffic) Order 2021
Notice is hereby given that the Essex County Council intends, not less than seven days from the date of this notice, to make the above Order under section 14(1) of the Road Traffic Regulation Act 1984.

Effect of the order: To temporarily close that length of Mill Lane, Chelmsford in the City of Chelmsford, from its junction with Pedlars Path for a distance of approximately 50m in a south easterly direction. The closure is scheduled to commence on 1st March 2021 for 5 days, or where stated on a valid permit (AZ7011001018158 – Cadent). The scheduled dates may vary for these works with appropriate signs showing and/or displayed on one.network. The closure is required for the safety of the public and workforce while connection works are undertaken by Cadent.

An alternative route is available via Hyde Lane, Maldon Road, Copt Hill, Gay Bowers Lane and vice versa.

The Order will come into effect on 18th February 2021 and may continue in force for 18 months or until the works have been completed, whichever is the earlier.

(Mill Lane, Little Baddow) (Temporary Prohibition of Traffic) Order 2021
Notice is hereby given that the Essex County Council intends, not less than seven days from the date of this notice, to make the above Order under section 14(1) of the Road Traffic Regulation Act 1984.

Effect of the order: To temporarily close that length of Mill Lane, Little Baddow in the City of Chelmsford, from a point approximately 60m northeast of its junction with The Ridge for a distance of approximately 80m in a northeasterly direction. The closure is scheduled to commence on 2nd March 2021 for 1 day, or where stated on a valid permit (BC0070GEA68015170 – BT). The scheduled dates may vary for these works with appropriate signs showing and/or displayed on one.network. The closure is required for the safety of the public and workforce while overhead cabling works are undertaken by BT.

An alternative route is available via The Ridge, Spring Elms Lane and vice versa. The Order will come into effect on 18th February 2021 and may continue in force for 18 months or until the works have been completed, whichever is the earlier.

(Park Road, Chelmsford) (Temporary Prohibition of Traffic) Order 2021
Notice is hereby given that the Essex County Council intends, not less than seven days from the date of this notice, to make the above Order under section 14(1) of the Road Traffic Regulation Act 1984.

Effect of the order: To temporarily close that length of Park Road, Chelmsford in the City of Chelmsford, from a point approximately 395m west of its junction with Ford End Road for a distance of approximately 60m in a westerly direction. The closure is scheduled to commence on 1st March 2021 for 15 days, or where stated on a valid permit (EC30091392635 – UK Power Networks). The scheduled dates may vary for these works with appropriate signs showing and/or displayed on one.network. The closure is required for the safety of the public and workforce while connection works are undertaken by UK Power Networks.

An alternative route is available via Vicarage Road, Back Lane, Pleshey Road, Ford End Road and vice versa.

The Order will come into effect on 18th February 2021 and may continue in force for 18 months or until the works have been completed, whichever is the earlier.

(Hawkswood Road, Chelmsford) (Temporary Prohibition of Traffic) Order 2021
Notice is hereby given that the Essex County Council has made the above Order under section 14(1) of the Road Traffic Regulation Act 1984.

Effect of the order: To temporarily close that length of Hawkswood Road, Chelmsford in the City of Chelmsford, from a point approximately 340m north west of its junction with South Hanningfield Road for a distance of approximately 255m in a north westerly direction. The closure is scheduled to commence on 17th February 2021 for 1 day, or where stated on a valid permit (BC008WC1T273S01 – BT). The scheduled dates may vary for these works with appropriate signs showing and/or displayed on one.network. The closure is required for the safety of the public and workforce while overhead cabling works are undertaken by BT.

An alternative route is available via Hawkswood Road, Downham Road, Stock Road, Ship Road, Holliday Hill, Church Road, Middlemead, South Hanningfield Road, Giffords Lane and vice versa.

The Order came into effect on 4th February 2021 and may continue in force for 18 months or until the works have been completed, whichever is the earlier.

(Kingsford Drive, Springfield) (Temporary Prohibition of Traffic) Order 2021
Notice is hereby given that the Essex County Council has made the above Order under section 14(1) of the Road Traffic Regulation Act 1984.

Effect of the order: To temporarily close that length of Kingsford Drive, Springfield in the City of Chelmsford, from its junction with Eglinton Drive to its junction with Silvester Way a distance of approximately 60m. The closure is scheduled to commence on 15th February

2021 for 1 day, or where stated on a valid permit (AD037R058213237 – Anglian Water). The scheduled dates may vary for these works with appropriate signs showing and/or displayed on one.network. The closure is required for the safety of the public and workforce while manhole cover and frame replacement works are undertaken by Anglian Water.

An alternative route is available via Whitmore Crescent, Eglinton Drive and vice versa.

The Order came into effect on 4th February 2021 and may continue in force for 18 months or until the works have been completed, whichever is the earlier.

(Moor Hall Lane, Chelmsford) (Temporary Prohibition of Traffic) Order 2021
Notice is hereby given that the Essex County Council has made the above Order under section 14(1) of the Road Traffic Regulation Act 1984.

Effect of the order: To temporarily close that length of Moor Hall Lane, Chelmsford in the City of Chelmsford, from a point approximately 25m south west of its junction Bicknacre Road for a distance approximately 80m in a south westerly direction. The closure is scheduled to commence on 15th February 2021 for 3 days, or where stated on a valid permit (BC008WBG853S17FEB – BT). The scheduled dates may vary for these works with appropriate signs showing and/or displayed on one.network. The closure is required for the safety of the public and workforce while service connection works are undertaken by BT.

An alternative route is available via Moor Hall Lane, Priory Road, Main Road, Bicknacre Road and vice versa.

The Order came into effect on 4th February 2021 and may continue in force for 18 months or until the works have been completed, whichever is the earlier.

(South Hanningfield Road, Chelmsford) (Temporary Prohibition of Traffic) Order 2021

Notice is hereby given that the Essex County Council has made the above Order under section 14(1) of the Road Traffic Regulation Act 1984.

Effect of the order: To temporarily close that length of South Hanningfield Road, Chelmsford in the City of Chelmsford, from a point approximately 135m south west of its junction with Middlemead for a distance of approximately 290m in a south westerly direction. The closure is scheduled to commence on 18th February 2021 for 1 day, or where stated on a valid permit (BC008PTMS180053A – BT). The scheduled dates may vary for these works with appropriate signs showing and/or displayed on one.network. The closure is required for the safety of the public and workforce while pole testing works are undertaken by BT.

An alternative route is available via South Hanningfield Road, Hawkswood Road, Downham Road, Stock Road, Ship Road, Holliday Hill, Church Road, Middlemead and vice versa.

The Order came into effect on 4th February 2021 and may continue in force for 18 months or until the works have been completed, whichever is the earlier.

(Various Roads, City of Chelmsford) (Temporary Prohibition of Traffic & Clearway & Temporary Introduction of 30mph Speed Limit) (No.1) Order 2021

Notice is hereby given that the Essex County Council has made the above Order under section 14(1) of the Road Traffic Regulation Act 1984.

Effect of the order:

- To temporarily close the various lengths of road in the City of Chelmsford as specified in the schedule to this Order.
- A temporary 'No Waiting, No Loading and No Stopping' restriction will be introduced on both sides of carriageway on the above lengths of roads for the duration of the closures to facilitate the works. Signs will be installed indicating when the No Waiting, No Loading and No Stopping restriction will be in force.
- To temporarily introduce a 30mph speed limit in the lengths of road as specified in the schedule.

"The Essex County Council (Chelmsford City) (Prohibition of Waiting, Loading and Stopping) and (On Street Parking Places) (Civil Enforcement Area) Consolidation Order 2019" will be temporarily amended to include the temporary 'No Waiting, No Loading and No Stopping at Any Time' restriction and suspend any existing parking and waiting restrictions on the above lengths of roads only. All other restrictions and exemptions contained in the aforementioned Order and Amendments to that Order shall remain in force.

The works being undertaken will take place within an 18-month period from 4th February 2021, exact dates will be specified on <http://roadworks.org/>. The roads will be closed to facilitate each phase of works and then re-opened to the public. Access will be maintained for emergency services. Diversion routes will be signed at each location and residents will be informed of the dates of each phase via letter/leaflet drop and advanced warning signs on the road.

For all enquiries please contact our Contact Centre on 0345 603 7631.

The Order came into effect on 4th February 2021 and may continue in force for 18 months or until the works have been completed, whichever is the earlier.

Road	Description	Schedule	Alternative Route
Timsons Lane, Springfield	from its junction with Springfield Road to its end a distance of approximately 258m		Peel Road, Springfield Road and vice versa
George Street, Chelmsford	from its junction with New Writtle Street to its junction with Anchor Street a distance of approximately 206m		Anchor Street, New London Road, New Writtle Street
New Writtle Street, Chelmsford	from its junction with New London Road to its junction with Moulsham Street a distance of approximately 134m		Diversion 1: New London Road, Parkway, Moulsham Street Diversion 2: New London Road, St Johns Road, Mildmay Road, Hall Street, Moulsham Street

DID YOU KNOW?
You can now book your
PUBLIC NOTICE
by visiting
bookanad.com



For help booking online call our team on
01227 907972
9am-5pm Mon-Fri

Self-Serve Online

Local pick up,
what a great idea



marketplacelive.co.uk