

ESSEX COUNTY COUNCIL

**PUBLIC PATH DIVERSION ORDER 2025
FOOTPATH 19 ARDLEIGH**

**IN
THE DISTRICT OF TENDRING**

**TOWN & COUNTRY PLANNING ACT 1990 - SECTION 257
PUBLIC PATH DIVERSION ORDER**

ESSEX COUNTY COUNCIL
TOWN & COUNTRY PLANNING ACT 1990 - SECTION 257
PUBLIC PATH DIVERSION ORDER
FOOTPATH 19 ARDLEIGH

This Order is made by Essex County Council (“the authority”) under section 257 (1A) of the Town & Country Planning Act 1990 (“the 1990 Act”) because it is satisfied that it is necessary to divert part of the footpath to which this order relates in order to enable development to be carried out in accordance with the planning application ESS/07/20/TEN made under Part III of the Town and Country Planning Act 1990 for the continuing of winning and working of minerals associated with the construction of a public water storage reservoir and the creation and rerouting of footpaths as described in the completed S106 Agreement dated 11th March 2010 subject to a Deed of Variation in relation to the planning application ESS/07/20/TEN which is seeking to vary the final permanent diverted route and Essex County Council is satisfied if granted it would be necessary to authorise the diversion in order to enable the development to be carried out.

BY THIS ORDER:



1. A part length of the footpath over the land situated at Ardleigh known as Footpath 19 Ardleigh in the District of Tendring and shown by a bold continuous line on the map numbered PROW-24-19 attached to this Order (“the Order Map”) and described in Part 1 of the Schedule to this Order shall be diverted as provided below.

2. There shall be created and waymarked to the reasonable satisfaction of Essex County Council an alternative highway as described in Part 2 of the Schedule for use as a replacement for the said footpath as shown by a bold broken line on the Order Map attached.

E01001

**DIVERSION OF FOOTPATH 19 ARDLEIGH
DISTRICT OF TENDRING
SECTION 257 TOWN & COUNTRY PLANNING ACT 1990**

Plan No. PROW-24-19
Key:

Route to Close A-B-C 
New Route A-C 
Unaffected Route 

Definitive Map Sheet TM02NW
Scale 1:2,500 (A2 paper)
Grid Reference at A 60256,22926
Post Code at A CO7 7QR

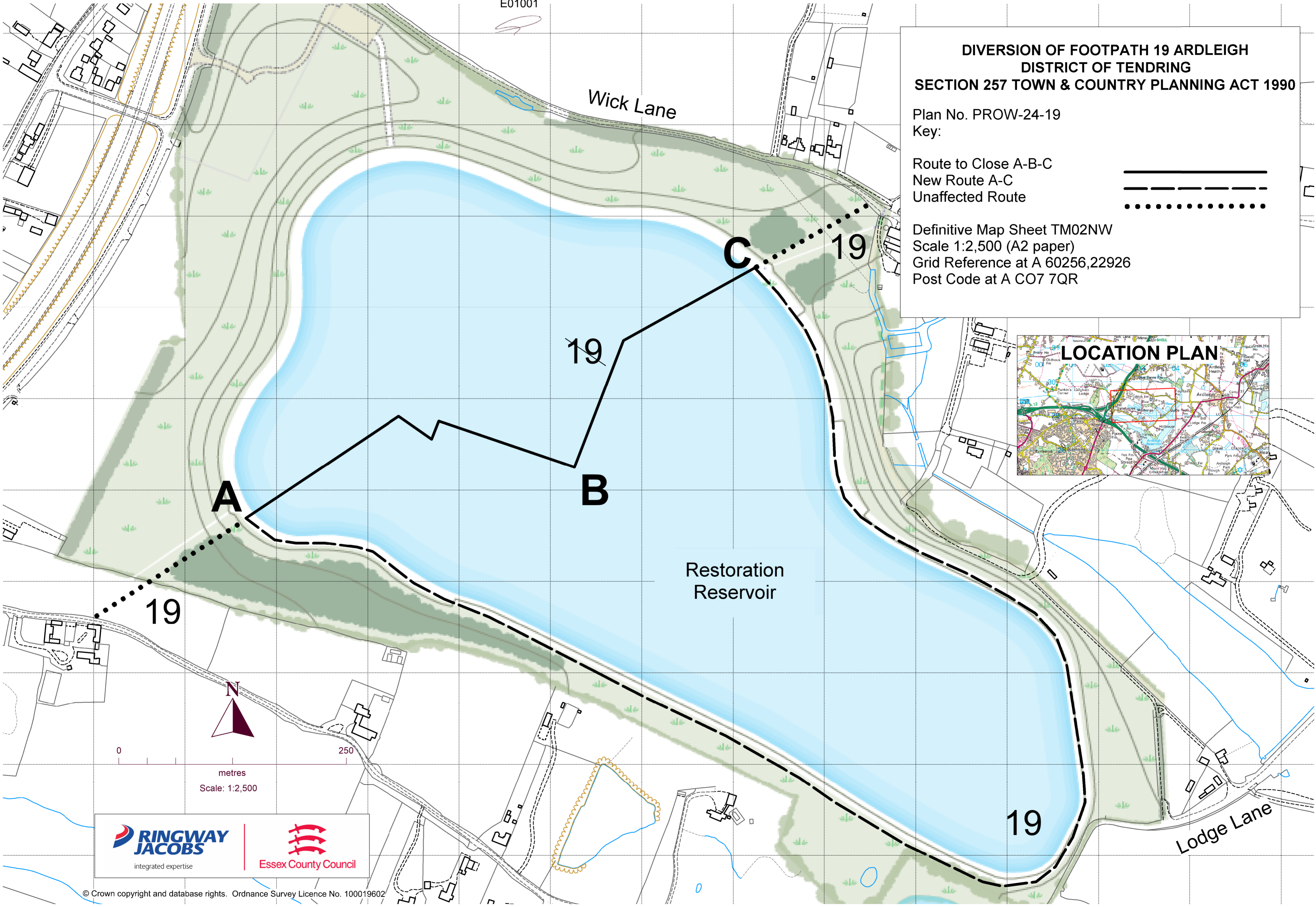
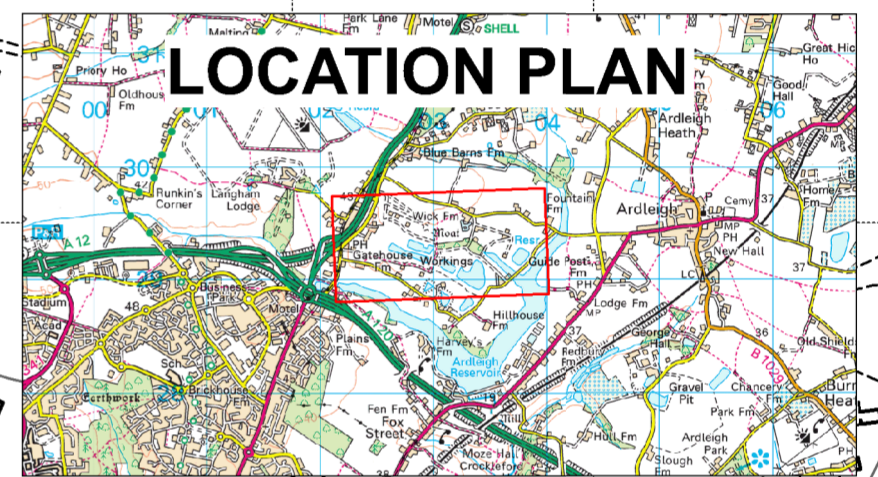

metres
Scale: 1:2,500



3. The diversion of the footpath shall have effect on the date on which Essex County Council as highway authority certify that the terms of Article 2 above have been complied with.

4. The applicant is hereby required to pay the full costs of seeking the diversion Order; this to include costs of advertising and administration, accommodation costs for any resulting hearing or inquiry, and the removal or abandonment of any apparatus, including the cost of providing any telecom apparatus rendered useless under, in, on, over, along or across the path to be stopped up.

5. Where immediately before the date on which part of the footpath is diverted, there is apparatus under, in, on, over, along or across it belonging to statutory undertakers for the purpose of carrying out their undertaking, the undertakers shall continue to have the same rights in respect of the apparatus as they then had.

SCHEDULE

[PART 1]

DESCRIPTION OF SITE OF EXISTING PATH OR WAY

A part length of Footpath 19 Ardleigh shown by a bold continuous line on the Order Map starting from point **A** at grid reference 60256,22926 running in a north easterly then south easterly direction for a distance of approximately 422 metres to point **B** at grid reference 60292,22932 then continuing in a generally north easterly direction for a final distance of approximately 311 metres to point **C** at grid reference 60312,22954 where it continues unaffected.

[PART 1]

DESCRIPTION OF SITE OF NEW PATH OR WAY

A Footpath being 2 metres in width shown by a bold broken line on the Order Map commencing at the aforementioned point **A** running in a south easterly then northerly then north westerly direction around the perimeter edge of the reservoir for a total distance of approximately 1,813 metres to the aforementioned point **C** where it continues unaffected.

The COMMON SEAL of ESSEX COUNTY COUNCIL was hereunto affixed on the thirtieth day of January 2025

in the presence of

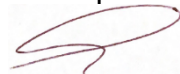

Michelle Nicoll
Attesting Officer

E01001

Dated: 30th day of January 2025

PUBLIC PATH DIVERSION ORDER

**TOWN & COUNTRY PLANNING ACT
1990 Section 257**

Footpath 19 Ardleigh in the
District of Tendring

Paul Turner
Director, Legal and Assurance

Seax House
Victoria Road South
Chelmsford
Essex
CM1 1QH