

ESSEX COUNTY COUNCIL

PUBLIC PATH DIVERSION ORDER 2022

FOOTPATH 2 FYFIELD

IN THE DISTRICT OF EPPING FOREST

HIGHWAYS ACT 1980 - SECTION 119

PUBLIC PATH DIVERSION ORDER

PUBLIC PATH DIVERSION ORDER
HIGHWAYS ACT 1980 – SECTION 119
ESSEX COUNTY COUNCIL
FOOTPATH 2 FYFIELD

This Order is made by Essex County Council (“the authority”) under section 119 of the Highways Act 1980 (“the 1980 Act”) because it appears to the authority that in the interest of the owner of the land crossed by the footpath described in paragraph 1 of this order it is expedient that the line of the path should be diverted.

The landowner has agreed to defray any compensation which becomes payable in consequence of the coming into force of this order and any expenses incurred in the order making and bringing the new site of the path into a fit condition for use by the public.

Epping Forest District Council have been consulted and have consented to the making of the order as required by section 120(2) of the 1980 Act.

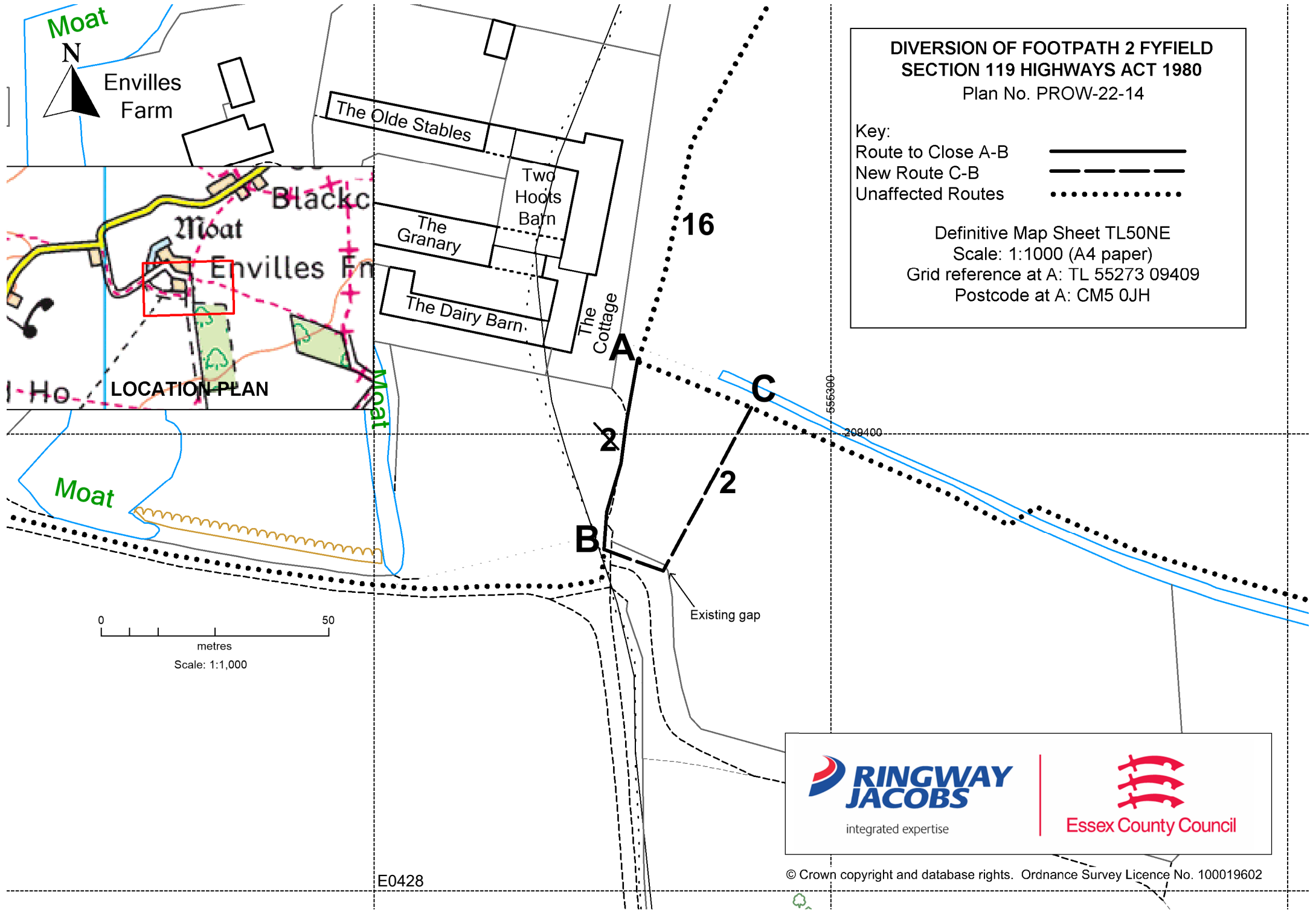

BY THIS ORDER:

- 1) The public right of way over the land situated immediately to the southeast of the property known as Envilles Farm in the parish of Fyfield known as Footpath 2 Fyfield in the District of Epping Forest and shown by a bold continuous black line on the order map numbered PROW-22-14 contained in this order and described in Part 1 of the Schedule to this order shall be stopped up after 35 days from the date of confirmation of this order.
- 2) There shall at the end of 28 days from the date of confirmation of this order be a public footpath over land situated immediately to the southeast of the property known as Envilles Farm in the parish of Fyfield known as Footpath 2 Fyfield in the District of Epping Forest as described in Part 2 of the Schedule and shown by a bold broken black line on the order map numbered PROW-22-14 contained in this order.
- 3) The rights conferred on the public under this order shall be subject to the limitations and conditions set out in Part 3 of the Schedule.



LOCATION PLAN

DIVERSION OF FOOTPATH 2 FYFIELD
SECTION 119 HIGHWAYS ACT 1980
 Plan No. PROW-22-14

Key:
 Route to Close A-B 
 New Route C-B 
 Unaffected Routes 

Definitive Map Sheet TL50NE
 Scale: 1:1000 (A4 paper)
 Grid reference at A: TL 55273 09409
 Postcode at A: CM5 0JH

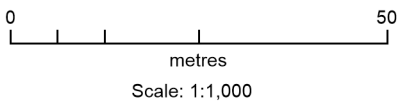

E0428

SCHEDULE

(PART 1)

DESCRIPTION OF SITE OF EXISTING PATH OR WAY

A part length of Footpath 2 Fyfield of unknown width shown by a bold continuous black line on the order map commencing from point **A** at grid reference TL 55257 09415 where it meets Footpath 16 Fyfield running in a southerly direction for a total distance of approximately 42 metres to point **B** at grid reference TL 55250 09374.

(PART 2)

DESCRIPTION OF SITE OF NEW PATH OR WAY

A footpath being 2 metres in width shown by a bold broken black line on the order map commencing at point **C** at grid reference TL 55282 09405 running in a southerly direction for a distance of approximately 41 metres before passing through a gap as described at Part 3 below then continuing in a westerly direction for a final distance of approximately 14 metres to the aforementioned point **B**.

(PART 3)

LIMITATIONS AND CONDITIONS

1.

At the point indicated on the Order Map (PROW-22-14) at the south eastern corner of the new path described in Part 2, (grid reference TL 55263 09370)

The right of the landowner to maintain a gap of 1.5 metres subject to its removal should the limitation become unnecessary whereby an available width shall remain of 2 metres, this being the dedicated width of the path as specified in Part 2 of the Schedule

The COMMON SEAL of the ESSEX COUNTY COUNCIL was hereunto affixed on the Eleventh day of July 2022

E0428

in the presence of
Jacqueline Millward
Attesting Officer

Dated: 11th day of July 2022

PUBLIC PATH DIVERSION ORDER

**HIGHWAYS ACT 1980
SECTION 119**

Footpath 2 in the parish of Fyfield in the
District of Epping Forest

Paul Turner
Director, Legal and Assurance

Seax House
Victoria Road South
Chelmsford
Essex
CM1 1QH