

ESSEX COUNTY COUNCIL

**PUBLIC PATH DIVERSION ORDER 2024
FOOTPATH 17 AND FOOTPATH 22 GREAT CANFIELD
IN THE DISTRICT OF UTTLESFORD**

**HIGHWAYS ACT 1980 - SECTION 119
PUBLIC PATH DIVERSION ORDER**

PUBLIC PATH DIVERSION ORDER

HIGHWAYS ACT 1980 – SECTION 119

ESSEX COUNTY COUNCIL

FOOTPATH 17 AND FOOTPATH 22 GREAT CANFIELD

This Order is made by Essex County Council (“the authority”) under section 119 of the Highways Act 1980 (“the 1980 Act”) because it appears to the authority that in the interest of the owners of the land crossed by the footpaths described in paragraph 1 of this order it is expedient that the line of the paths should be diverted.

The landowners have agreed to defray any compensation which becomes payable in consequence of the coming into force of this order and any expenses incurred in the order making and bringing the new site of the path into a fit condition for use by the public.

Uttlesford District Council have been consulted as required by section 120(2) of the 1980 Act.

BY THIS ORDER:

1) The public rights of way over the land situated west and south east of The Hall in Great Canfield known as Footpath 17 and Footpath 22 Great Canfield in the District of Uttlesford and shown by bold broken lines on the order maps numbered PROW-24-11 rev.17.09.24 and PROW-24-12 rev.03.06.24 contained in this order and described in Part 1 of the Schedule to this order shall be stopped up after 35 days from the date of confirmation of this order.

2) There shall at the end of 28 days from the date of confirmation of this order be public footpaths over land situated west and south east of The Hall in Great Canfield known as Footpath 17 and Footpath 22 Great Canfield in the District of Uttlesford as described in Part 2 of the Schedule and shown by bold broken lines on the order maps numbered PROW-24-11 rev.17.09.24 and PROW-24-12 rev.03.06.24 contained in this order.

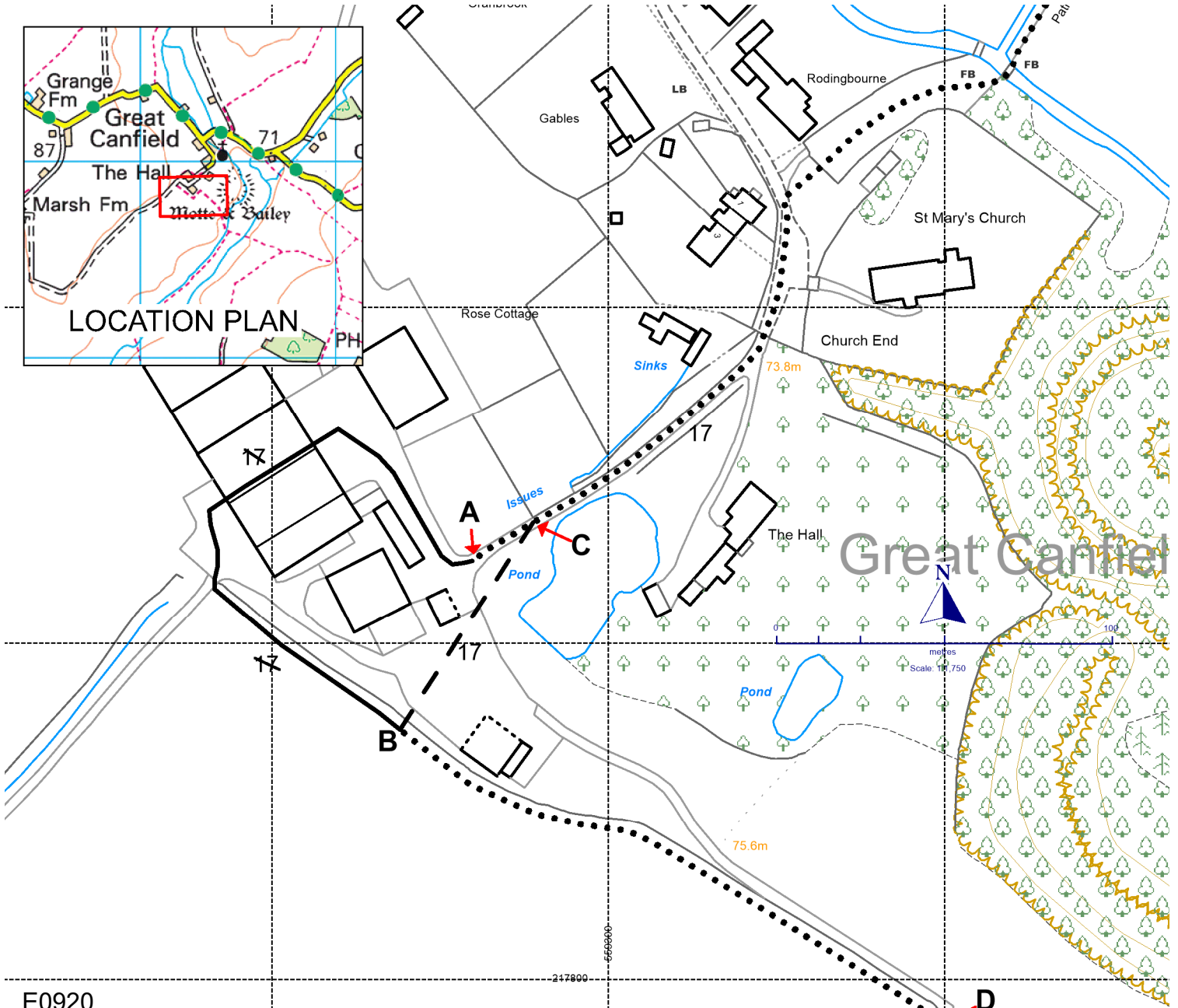

E0920

**DIVERSION OF PART OF FOOTPATH 17 GREAT CANFIELD
UTTLESFORD DISTRICT
SECTION 119 HIGHWAYS ACT 1980**

Plan No. PROW-24-11 rev.17.09.24

Routes to Close A-B, D-E

New Routes C-B, D-F

Unaffected Routes

Definitive Map Sheet TL51NE

Scale 1:1,750 (A4 paper)

Grid Reference at A 55925,21792

Post Code at A CM6 1JT

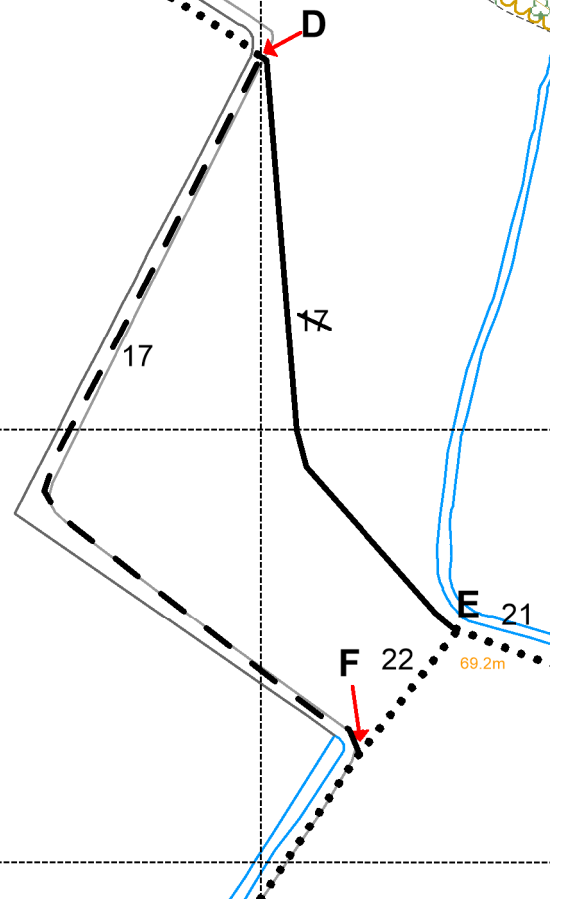

integrated expertise



Essex County Council

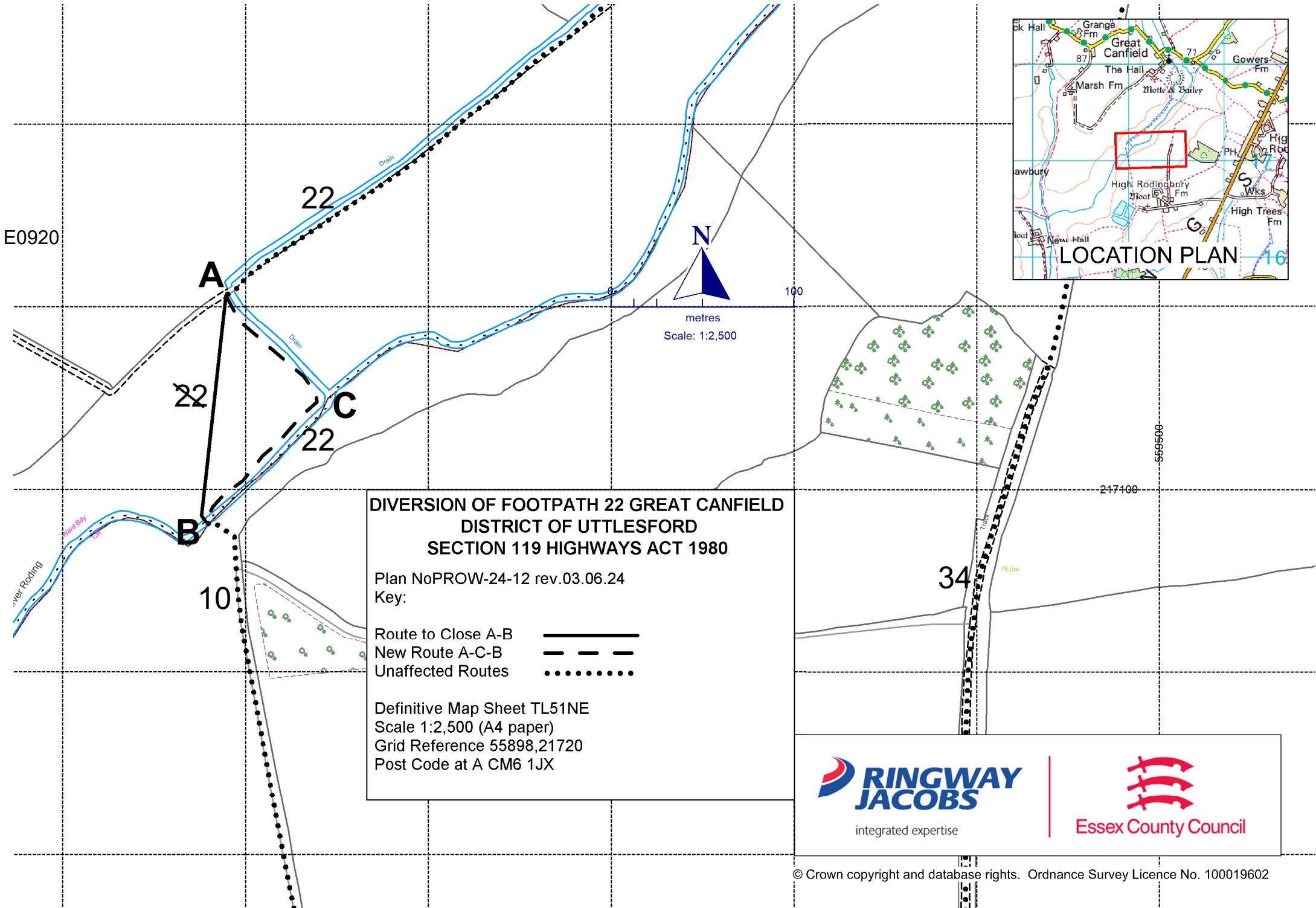

**DIVERSION OF FOOTPATH 22 GREAT CANFIELD
DISTRICT OF UTTLESFORD
SECTION 119 HIGHWAYS ACT 1980**

Plan NoPROW-24-12 rev.03.06.24
Key:

Route to Close A-B **—————**
 New Route A-C-B **- - - - -**
 Unaffected Routes **.....**

Definitive Map Sheet TL51NE
 Scale 1:2,500 (A4 paper)
 Grid Reference 55898,21720
 Post Code at A CM6 1JX



integrated expertise



Essex County Council

SCHEDULE

(PART 1)

DESCRIPTION OF SITE OF EXISTING PATHS OR WAYS

Footpath 17 Great Canfield

A-B

A part length of Footpath 17 Great Canfield of unknown width shown by a bold continuous line on the order map PROW-24-11 rev.17.09.24 commencing from point **A** at grid reference 55925,21792 where an access track meets the farmyard running in a north westerly, south westerly, southerly then south easterly direction around and through farm buildings and around a field edge for a total distance of approximately 198 metres to point **B** at grid reference 55923,21787 where it continues unaffected.

D-E

A further section of Footpath 17 Great Canfield of unknown width shown by a bold continuous line on the order map PROW-24-11 rev.17.09.24 commencing from point **D** at grid reference 55940,21778 located at the field edge running across the field in a generally south easterly direction for a total distance of approximately 146 metres to point **E** at grid reference 55944,21765 at the field edge where it connects to Footpath 21 and Footpath 22 Great Canfield and continues unaffected.

Footpath 22 Great Canfield

A-B

A part length of Footpath 22 Great Canfield of unknown width shown by a bold continuous line on the order map PROW-24-12 rev.03.06.24 commencing from point **A** at grid reference 55898,21720 at a field edge running in a generally southerly direction across a field for a total distance of approximately 124 metres to point **B** at grid reference 55897,21708 where it connects to footpath 10 High Roding.

(PART 2)
DESCRIPTION OF SITE OF NEW PATHS OR WAYS

Footpath 17 Great Canfield

C-B

A footpath being 2 metres in width shown by a bold broken line on the order map PROW-24-11 rev.17.09.24 commencing at point **C** at grid reference 55927,21793 located on an access track west of a pond running in a south westerly direction across a farm yard area and through a gap in a hedge for a total distance of approximately 73 metres to the aforementioned point **B** where it continues unaffected.

D-F

A further section of footpath being 2 metres in width shown by a bold broken line on the order map PROW-24-11 rev.17.09.24 commencing at the aforementioned point **D** running in a south westerly then south easterly direction around a field edge for a total distance of approximately 208 metres to point **F** at grid reference 55942,21762 where it connects to Footpath 22 Great Canfield.

Footpath 22 Great Canfield

A-C-B

A footpath being 2 metres in width shown by a bold broken line on the order map PROW-24-12 rev.03.06.24 commencing at the aforementioned point **A** running in a south easterly direction around the field edge for a distance of approximately 78 metres to point **C** at grid reference 55903,21714 in the corner of the field where it continues in a south westerly direction along the field edge for a final distance of approximately 89 metres to the aforementioned point **B** where it connects to Footpath 10 High Roding.

The COMMON SEAL of ESSEX COUNTY COUNCIL was hereunto affixed on the
Twenty Fifth day of September 2024.

in the presence of



Michelle Nicoll
Attesting Officer

E0920

Dated: 25th September 2024

PUBLIC PATH DIVERSION ORDER

**HIGHWAYS ACT 1980
SECTION 119**

Footpath 17 and Footpath 22 Great Canfield
in the District of Uttlesford

Paul Turner
Director, Legal and Assurance

Seax House
Victoria Road South
Chelmsford
Essex
CM1 1QH