

ESSEX COUNTY COUNCIL

PUBLIC PATH DIVERSION ORDER 2025

FOOTPATH 29 HATFIELD PEVEREL

IN THE DISTRICT OF BRAINTREE

HIGHWAYS ACT 1980 - SECTION 119

PUBLIC PATH DIVERSION ORDER

PUBLIC PATH DIVERSION ORDER
HIGHWAYS ACT 1980 – SECTION 119
ESSEX COUNTY COUNCIL
FOOTPATH 29 HATFIELD PEVEREL

This Order is made by Essex County Council (“the authority”) under section 119 of the Highways Act 1980 (“the 1980 Act”) because it appears to the authority that in the interest of the owner of the land crossed by the footpath described in paragraph 1 of this order it is expedient that the line of the path should be diverted.

Louise Thomson has agreed to defray any compensation which becomes payable in consequence of the coming into force of this order and any expenses incurred in the order making and bringing the new site of the path into a fit condition for use by the public.

Braintree District Council has been consulted as required by section 120(2) of the 1980 Act.

BY THIS ORDER:

- 1) The public right of way over the land situated at Chase Cottage and Sandford’s Farm Wickham Bishops Road in Hatfield Peverel known as Footpath 29 Hatfield Peverel in the District of Braintree and shown by a bold continuous black line on the order map numbered PROW-20-01 Oct2024 contained in this order and described in Part 1 of the Schedule to this order shall be stopped up after 35 days from the date of confirmation of this order.
- 2) Notwithstanding this order UK Power Networks shall have the same rights of access to apparatus they once had prior to the confirmation of this order.
- 3) There shall at the end of 28 days from the date of confirmation of this order be a public footpath over land situated at Chase Cottage and Sandford’s Farm Wickham Bishops Road in Hatfield Peverel known as Footpath 29 Hatfield Peverel in the District of Braintree and described in Part 2 of the Schedule and shown by a bold broken black line on the order map numbered PROW-20-01 Oct2024 contained in this order.

DIVERSION OF FOOTPATH 29 HATFIELD PEVEREL
DISTRICT OF BRAINTREE
SECTION 119 HIGHWAYS ACT 1980

Plan No. PROW-20-01 Oct2024

Route to Close A-B-C-D 

New Route A-E-F-D 

Unaffected Routes 

Definitive Map Sheet TL81SW Scale 1:1000 at A4

Grid Ref at A 580898 211918

Post Code at Chase Cottage - CM3 2JL

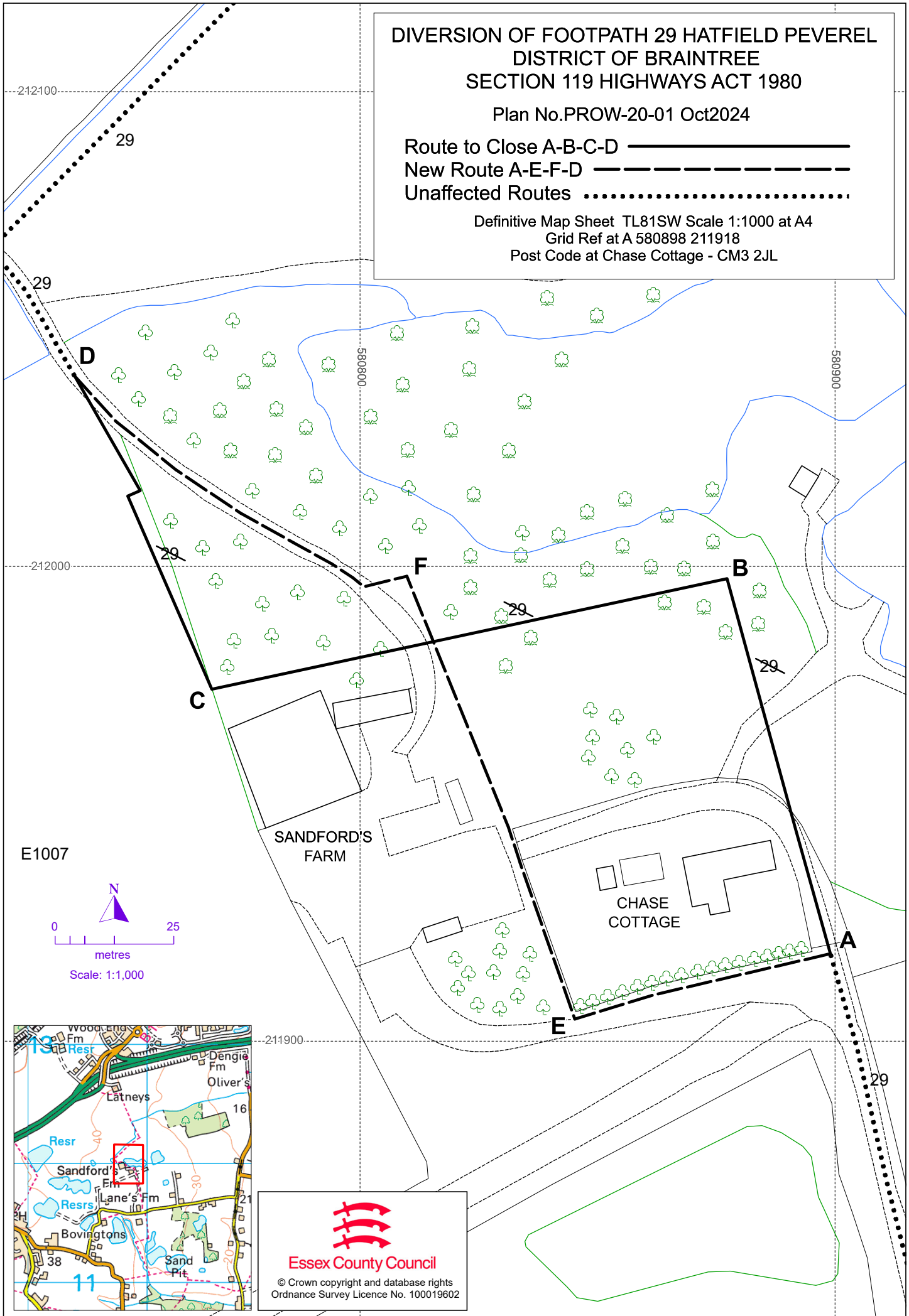

E1007

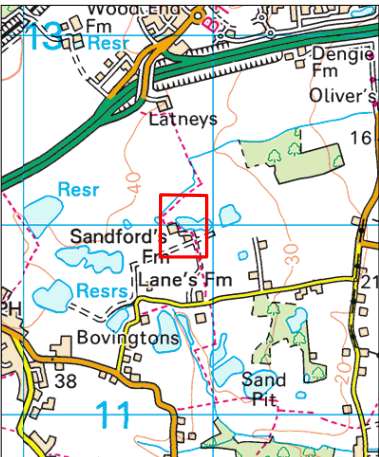
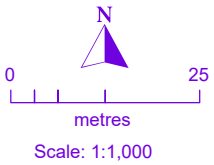

Essex County Council

© Crown copyright and database rights
Ordnance Survey Licence No. 100019602

SCHEDULE

(PART 1)

DESCRIPTION OF SITE OF EXISTING PATH OR WAY

A part length of Footpath 29 Hatfield Peverel of unknown width shown by a bold continuous black line on the order map commencing from point **A** at grid reference 58089,21191 approximately 2 metres south of the entrance gateway into Chase Cottage garden proceeding in a north north-westward direction through the gateway access and along the driveway then through a boundary fence into wooded scrubland for a distance of approximately 82 metres to point **B** at grid reference 58087,21199 then continuing in a west south-westward direction through the wooded scrubland passing north of Sandford's Farm outbuildings to the western side of the hedge boundary for a further distance of approximately 110 metres to point **C** at grid reference 58076,21197 at the field edge. The path then proceeds in a general north north-westward direction at the field edge for a final distance of approximately 75 metres to point **D** at grid reference 58073,21204 approximately 20 metres southeast of the hedge gap into the next field.

(PART 2)

DESCRIPTION OF SITE OF NEW PATH OR WAY

A footpath being 2 metres in width shown by a bold broken black line on the order map commencing from the aforementioned point **A** south of the Chase Cottage gateway proceeding in a west south-westward direction adjacent to the boundary fencing for a distance of approximately 56 metres to point **E** at grid reference 58084,21190 where it continues in a north north-westward direction on the western side of the Chase Cottage garden fence for a further distance of approximately 100 metres to point **F** at grid reference 58080,21199. The path then continues initially in a west south-westward direction for a distance of approximately 10 metres before heading in a north westward direction through the thicket for a final distance of approximately 75 metres to the aforementioned point **D** at the field edge where it continues unaffected as Footpath 29 Hatfield Peverel. Between Points **A** to **E** there shall be a safeguard width of 2 metres from the south side of Chase Cottage garden fencing to the northern edge of the Footpath.

The COMMON SEAL of ESSEX COUNTY COUNCIL was hereunto affixed on the
Tenth day of February 2025

in the presence of

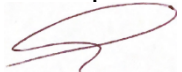

Michelle Nicoll
Attesting Officer

E1007

Dated: 10th day of February 2025

PUBLIC PATH DIVERSION ORDER

**HIGHWAYS ACT 1980
SECTION 119**

Footpath 29 in the parish of Hatfield
Peveler in the District of Braintree

Paul Turner
Director, Legal and Assurance

Essex Legal Services
Seax House
Victoria Road South
Chelmsford
Essex
CM1 1QH