

ESSEX COUNTY COUNCIL

PUBLIC PATH EXTINGUISHMENT ORDER 2024

FOOTPATH 26 HIGH LAVER

IN THE DISTRICT OF EPPING FOREST

HIGHWAYS ACT 1980 - SECTION 118

PUBLIC PATH DIVERSION ORDER

ESSEX COUNTY COUNCIL
HIGHWAYS ACT 1980 – SECTION 118
PUBLIC PATH EXTINGUISHMENT ORDER
FOOTPATH 26 HIGH LAVER

This Order is made by Essex County Council (“the authority”) under section 118 of the Highways Act 1980 (“the 1980 Act”) because it appears to the authority that the footpath described in paragraph 1 below is not needed for public use.

Epping Forest District Council have been consulted as required by section 120(2) of the 1980 Act.

BY THIS ORDER:

1) A part length of the public right of way over the land situated to the east of High Laver House known as Footpath 26 High Laver in the District of Epping Forest and shown by a bold continuous line on the order map numbered PROW-24-13 contained in this order and described in Part 1 of the Schedule to this order shall be extinguished on the date of confirmation of this order.

Essex County Council
2024.12.11 13:32:48
Z



0 100
metres
Scale: 1:1,200

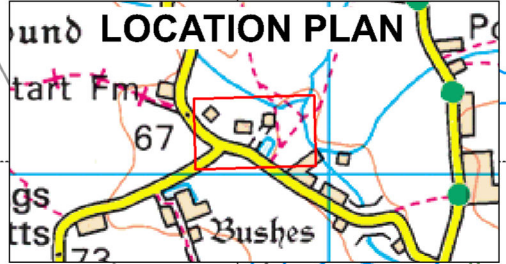

**EXTINGUISHMENT OF FOOTPATH 26 HIGH LAVER
DISTRICT OF EPPING FOREST
SECTION 118 HIGHWAYS ACT 1980**

Plan no. PROW-24-13
Key:
Route to Close A-B-C —————
Unaffected Route
Definitive Map Sheet TL50NW
Scale 1:1200 (A4 paper)
Grid Reference at A 55285, 20802
Post Code at A CM5 0DR

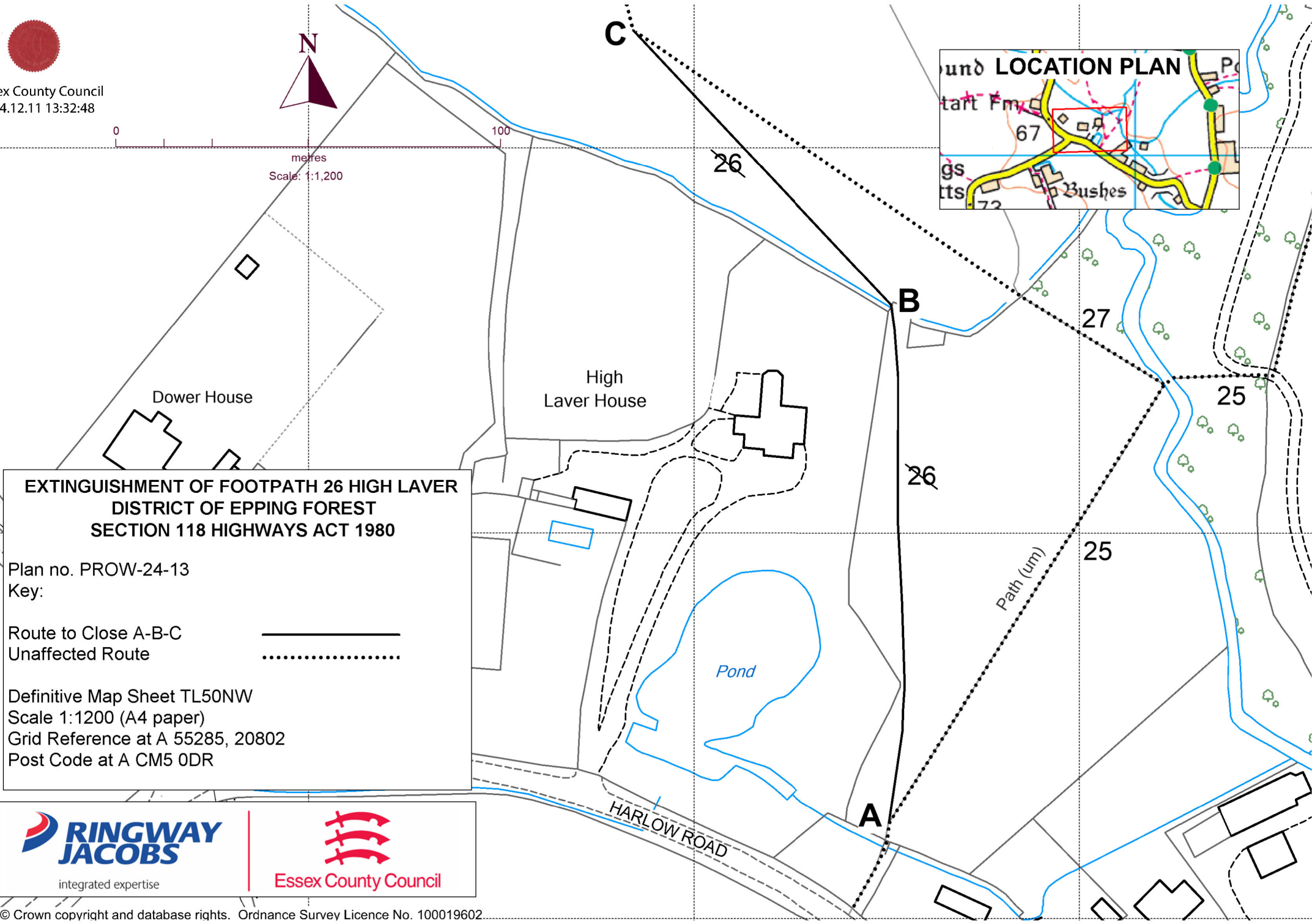

SCHEDULE

(PART 1)

DESCRIPTION OF SITE OF EXISTING PATH OR WAY TO BE EXTINGUISHED

A part length of Footpath 26 High Laver of unknown width shown by a bold continuous line on the order map commencing from point **A** at grid reference 55285,20802 where it connects to Footpath 25 High Laver running in a northerly direction for approximately 135 metres to a ditch crossing at point **B** at grid reference 55285,20815 then continuing in a north westerly direction for a final distance of approximately 98 metres to point **C** at grid reference 55278,20823 where it connects to Footpath 27 High Laver and continues unaffected.

The COMMON SEAL of ESSEX COUNTY COUNCIL was hereunto affixed on the
Eleventh day of December 2024.

in the presence of

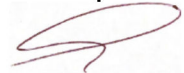

Michelle Nicoll
Attesting Officer



Essex
County
Council

2024.12.1

1 13:32:17

Z

E0978

Dated: 11th day of December 2024

**PUBLIC PATH EXTINGUISHMENT
ORDER**

**HIGHWAYS ACT 1980
SECTION 118**

Footpath 26 in the parish of High Laver in
the District of Epping Forest

Paul Turner
Director, Legal and Assurance

Seax House
Victoria Road South
Chelmsford
Essex
CM1 1QH

HIGHWAYS ACT 1980

SECTION 118

PUBLIC PATH EXTINGUISHMENT ORDER 2024

FOOTPATH 26 HIGH LAVER

IN THE DISTRICT OF EPPING FOREST

ESSEX COUNTY COUNCIL in exercise of the powers conferred upon them in that behalf, hereby confirm the foregoing Order:

THIS ORDER IS HEREBY CONFIRMED AS UNOPPOSED ORDER

The COMMON SEAL of the ESSEX COUNTY COUNCIL was hereunto affixed on the Fourteenth Day of March 2025

E1025

in the presence of



Micah Mitchell
Attesting Officer

Dated: 14th March 2025

CONFIRMATION ORDER

PUBLIC PATH EXTINGUISHMENT ORDER

**HIGHWAYS ACT 1980
SECTION 118**

Footpath 26 in the parish of High Laver in
the District of Epping Forest

Paul Turner
Director, Legal and Assurance
Seax House
Victoria Road South
Chelmsford
Essex
CM1 1QH