

ESSEX COUNTY COUNCIL

PUBLIC PATH DIVERSION ORDER 2022

FOOTPATHS 29 & 26 LANGHAM

IN THE BOROUGH OF COLCHESTER

HIGHWAYS ACT 1980 - SECTION 119

PUBLIC PATH DIVERSION ORDER

PUBLIC PATH DIVERSION ORDER
HIGHWAYS ACT 1980 – SECTION 119
ESSEX COUNTY COUNCIL
FOOTPATHS 29 & 26 LANGHAM

This Order is made by Essex County Council (“the authority”) under section 119 of the Highways Act 1980 (“the 1980 Act”) because it appears to the authority that in the interest of the owner of the land crossed by the footpath described in paragraph 1 of this order it is expedient that the line of the path should be diverted.

The landowner has agreed to defray any compensation which becomes payable in consequence of the coming into force of this order and any expenses incurred in the order making and bringing the new site of the path into a fit condition for use by the public.

Colchester Borough Council have been consulted.

BY THIS ORDER:

- 1) The public rights of way over the land situated north of Langham Oaks School known as Footpaths 29 and 26 Langham in the Borough of Colchester and shown by bold continuous lines on the order map numbered PROW-22-20 rev.12.10.22 contained in this order and described in Part 1 of the Schedule to this order shall be stopped up after 35 days from the date of confirmation of this order.
- 2) There shall at the end of 28 days from the date of confirmation of this order be public footpaths over land situated north of Langham Oaks School known as Footpaths 29 and 26 Langham in the Borough of Colchester as described in Part 2 of the Schedule and shown by bold broken lines on the order map numbered PROW-22-20 rev.12.10.22 contained in this order.

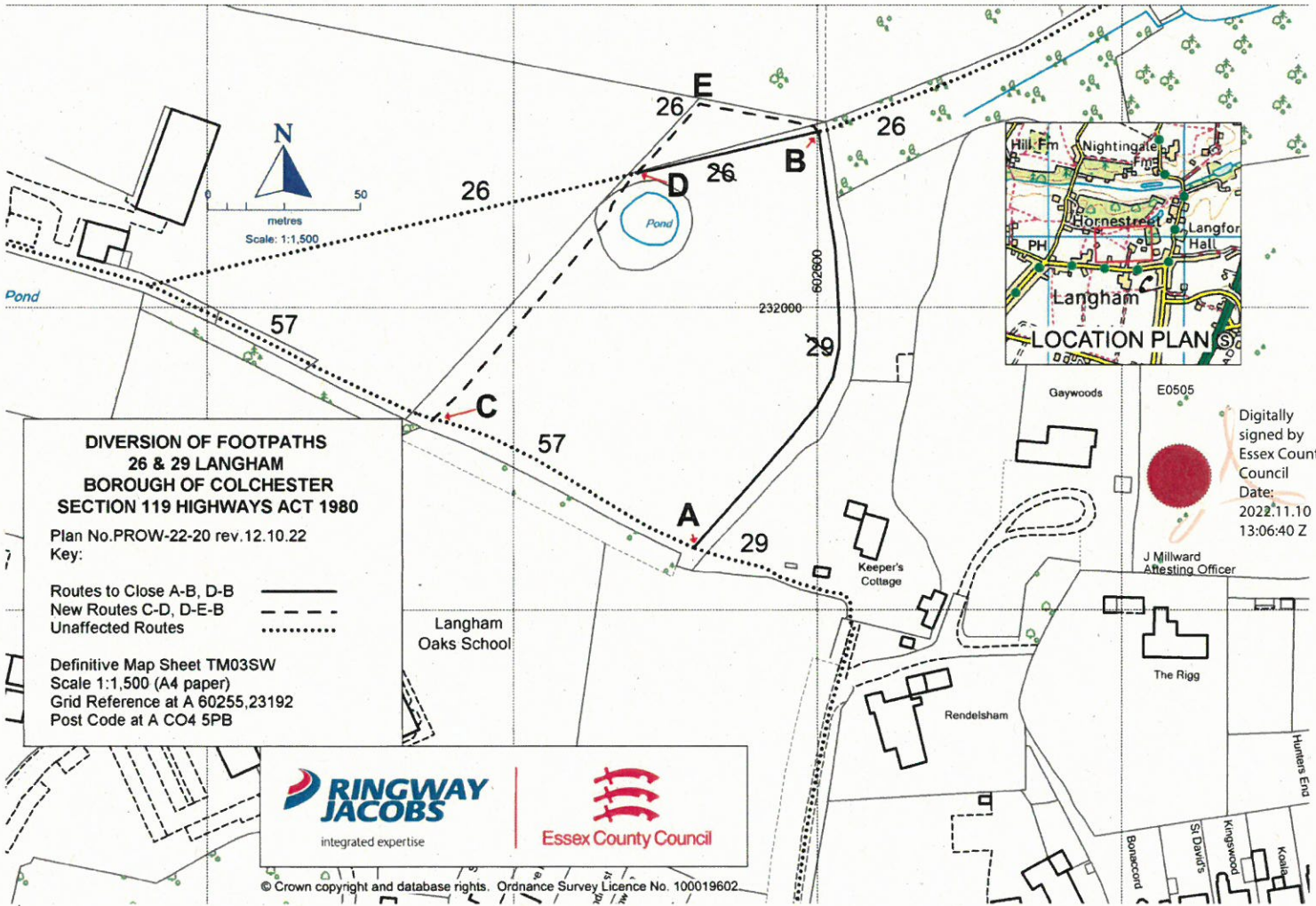

**DIVERSION OF FOOTPATHS
26 & 29 LANGHAM
BOROUGH OF COLCHESTER
SECTION 119 HIGHWAYS ACT 1980**

Plan No. PROW-22-20 rev. 12.10.22
Key:

Routes to Close A-B, D-B ———
New Routes C-D, D-E-B - - - - -
Unaffected Routes
Langham Oaks School

Definitive Map Sheet TM03SW
Scale 1:1,500 (A4 paper)
Grid Reference at A 60255,23192
Post Code at A CO4 5PB

Digitally signed by Essex County Council
Date: 2022.11.10 13:06:40 Z
J Millward Attesting Officer

RINGWAY JACOBS | **Essex County Council**
integrated expertise

© Crown copyright and database rights. Ordnance Survey Licence No. 100019602

SCHEDULE

(PART 1)

DESCRIPTION OF SITE OF EXISTING PATHS OR WAYS

Footpath 29 Langham

A part length of Footpath 29 part of unknown width and part of 2 metres width shown by a bold continuous line on the order map commencing from point **A** at grid reference 60255,23192 at the south east corner of a field running in a north easterly then generally northerly direction for a total distance of approximately 154 metres to point **B** at grid reference 60260,23205 where it connects with Footpath 26 Langham.

Footpath 26 Langham

A part length of Footpath 26 of unknown width shown by a bold continuous line on the order map commencing from point **D** at grid reference 60254,23204 north of a pond running in a north easterly direction across a field for a total distance of approximately 60 metres to the aforementioned point **B** where it continues unaffected.

(PART 2)

DESCRIPTION OF SITE OF NEW PATHS OR WAYS

Footpath 29 Langham

A footpath being 2 metres in width shown by a bold broken line on the order map commencing at point **C** at grid reference 60247,23196 in the south west corner of a field running in a north easterly direction along the field edge and around a pond for a total distance of approximately 107 metres to the aforementioned point **D** where it connects to Footpath 26 Langham.

Footpath 26 Langham

A footpath being 2 metres in width shown by a bold broken line on the order map commencing at the aforementioned point **D** running in a north easterly direction along the field edge for a distance of approximately 30 metres to point **E** at grid reference 60256,23206 where it continues in an east south easterly direction around the field edge adjacent to a wooded area for a final distance of approximately 41 metres to the aforementioned point **B** where it continues unaffected.

The COMMON SEAL of the ESSEX COUNTY COUNCIL was hereunto affixed on the Tenth day of November 2022

E0505

In the presence of
Jacqueline Millward
Attesting Officer

 Digitally
signed by
Essex
County
Council
Date:
2022.11.10
13:09:01 Z

The foregoing order is hereby confirmed

Catherine Beeby 1 MAY 2024
An Inspector appointed by The Secretary
of State for Environment, Food and
Rural Affairs

Dated: 10th day of November 2022

PUBLIC PATH DIVERSION ORDER

**HIGHWAYS ACT 1980
SECTION 119**

Footpaths 29 & 26 in Langham in the
Borough of Colchester

Paul Turner
Director, Legal and Assurance

Seax House
Victoria Road South
Chelmsford
Essex
CM1 1QH