

ESSEX COUNTY COUNCIL

PUBLIC PATH DIVERSION ORDER 2022

FOOTPATH 10 SOUTHMINSTER

IN THE DISTRICT OF MALDON

HIGHWAYS ACT 1980 - SECTION 119

PUBLIC PATH DIVERSION ORDER

PUBLIC PATH DIVERSION ORDER
HIGHWAYS ACT 1980 – SECTION 119
ESSEX COUNTY COUNCIL
FOOTPATH 10 SOUTHMINSTER

This Order is made by Essex County Council (“the authority”) under section 119 of the Highways Act 1980 (“the 1980 Act”) because it appears to the authority that in the interest of the owner of the land crossed by the footpath described in paragraph 1 of this order it is expedient that the line of the path should be diverted.

The Applicant has agreed to defray any compensation which becomes payable in consequence of the coming into force of this order and any expenses incurred in the order making and bringing the new site of the path into a fit condition for use by the public.

Maldon District Council have been consulted and have consented to the making of the order as required by section 120(2) of the 1980 Act.

BY THIS ORDER:

- 1) The public right of way over the land situated immediately to the south east of the property known as Caidge Farm in the parish of Southminster known as Footpath 10 Southminster in the District of Maldon and shown by a bold continuous black line on the order map numbered PROW-22-17 contained in this order and described in Part 1 of the Schedule to this order shall be stopped up after 35 days from the date of confirmation of this order.

- 2) There shall at the end of 28 days from the date of confirmation of this order be a public footpath over land situated immediately to the south east of the property known as Caidge Farm in the parish of Southminster known as Footpath 10 Southminster in the District of Maldon as described in Part 2 of the Schedule and shown by a bold broken black line on the order map numbered PROW-22-17 contained in this order



DIVERSION OF FOOTPATH 10 SOUTHMINSTER
SECTION 119 HIGHWAYS ACT 1980
 Plan no. PROW-22-17

- Key:
- Route to Close A-B-C
 - New Route A-C
 - Unaffected Routes

Definitive Map Sheet TQ99NW Scale 1:2500 at A4
 Grid Ref at A: TQ 94877 99415
 Postcode at A: CM0 7FQ

E0437
 in the presence of
 J Millward
 Attesting Officer

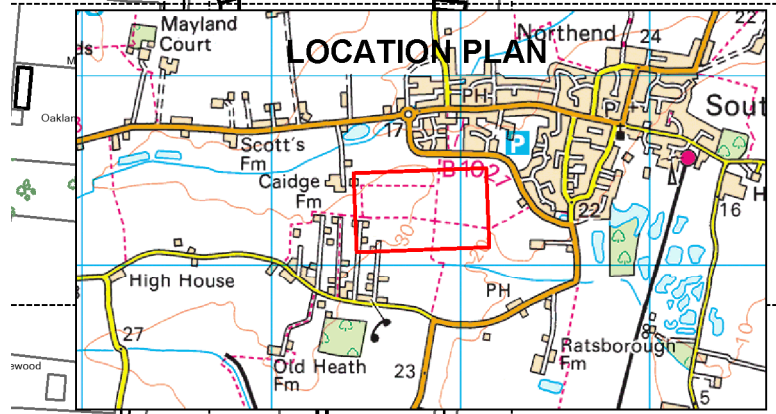
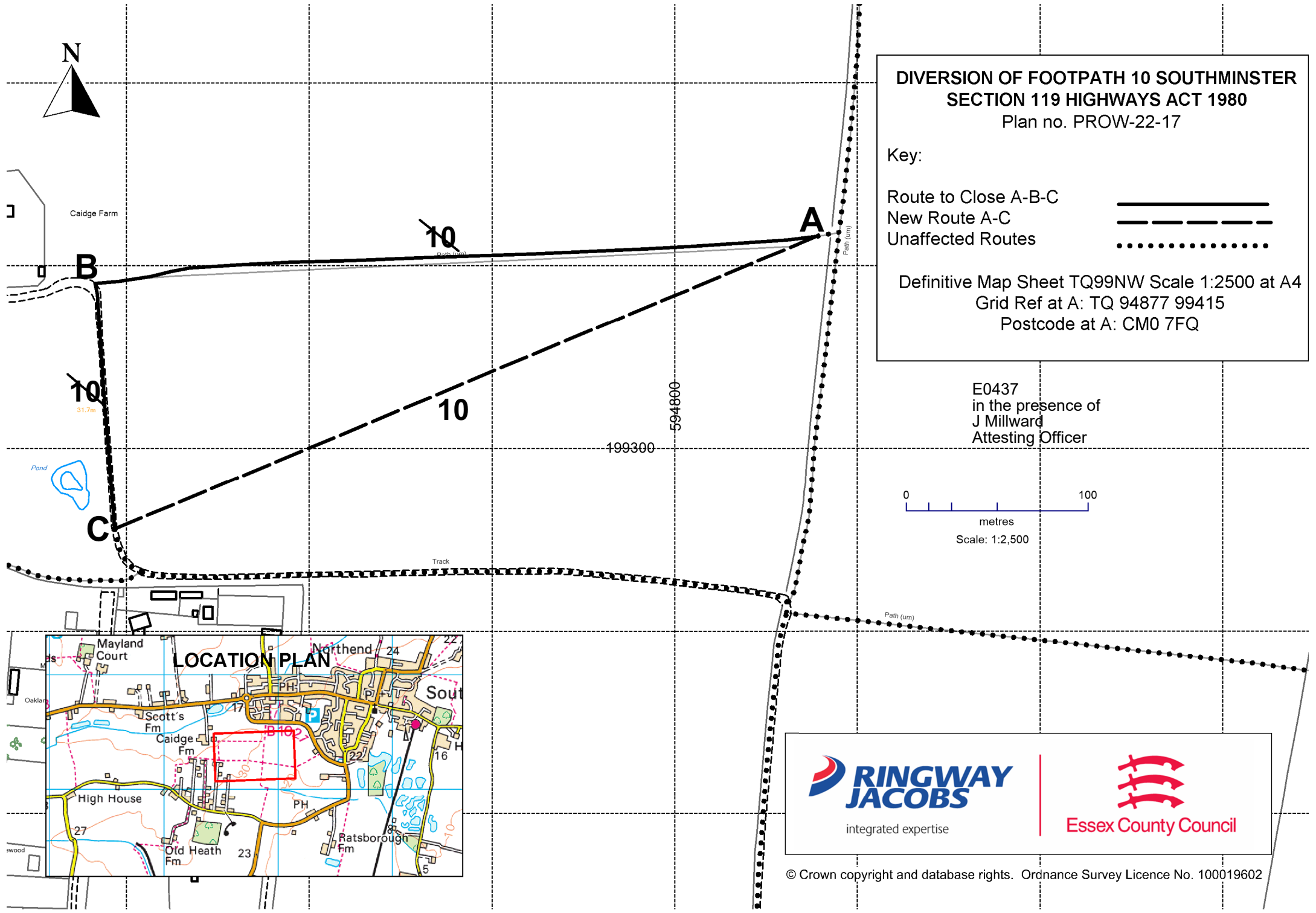
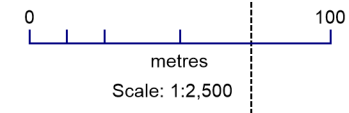



integrated expertise



Essex County Council

SCHEDULE

(PART 1)

DESCRIPTION OF SITE OF EXISTING PATH OR WAY

A part length of Footpath 10 Southminster of unknown width shown by a bold continuous black line on the order map commencing from point **A** at grid reference TQ 94877 99415 running in a westerly direction to point **B** at grid reference TQ 94482 99390 then in a southerly direction for a total distance of approximately 529 metres to point **C** at grid reference TQ 94493 99255.

(PART 2)

DESCRIPTION OF SITE OF NEW PATH OR WAY

A footpath being 2 metres in width shown by a bold broken black line on the order map commencing at the aforementioned point **A** running in a south westerly direction for a total distance of approximately 415 metres to the aforementioned point **C**.

The COMMON SEAL of the ESSEX COUNTY COUNCIL was hereunto affixed on the Twenty First day of July 2022

E0437

in the presence of
Jacqueline Millward
Attesting Officer:

Dated: 21st day of July 2022

PUBLIC PATH DIVERSION ORDER

**HIGHWAYS ACT 1980
SECTION 119**

Footpath 10 in the parish of Southminster
in the District of Maldon

Paul Turner
Director, Legal and Assurance

Seax House
Victoria Road South
Chelmsford
Essex
CM1 1QH