

ESSEX COUNTY COUNCIL

PUBLIC PATH DIVERSION ORDER 2025

FOOTPATH 16 WOODHAM WALTER

IN THE DISTRICT OF MALDON

HIGHWAYS ACT 1980 - SECTION 119

PUBLIC PATH DIVERSION ORDER

PUBLIC PATH DIVERSION ORDER
HIGHWAYS ACT 1980 – SECTION 119
ESSEX COUNTY COUNCIL
FOOTPATH 16 WOODHAM WALTER

This Order is made by Essex County Council (“the authority”) under section 119 of the Highways Act 1980 (“the 1980 Act”) because it appears to the authority that in the interest of the owners of the land crossed by the footpaths described in paragraph 1 of this order it is expedient that the lines of the path should be diverted.

The landowners have agreed to defray any compensation which becomes payable in consequence of the coming into force of this order and any expenses incurred in the order making and bringing the new site of the path into a fit condition for use by the public.

Maldon District Council have been consulted as required by section 120(2) of the 1980 Act.

BY THIS ORDER:

- 1) The public right of way over the land situated west of The Rookery and north of Tom Tit Lane in Woodham Walter known as Footpath 16 Woodham Walter in the District of Maldon and shown by bold broken lines on the order maps numbered PROW-24-23 rev.15.10.24 and PROW-24-30 rev.04.11.24 contained in this order and described in Part 1 of the Schedule to this order shall be stopped up after 35 days from the date of confirmation of this order.

- 2) There shall at the end of 28 days from the date of confirmation of this order be a public footpath over land situated west of The Rookery and north of Tom Tit Lane in Woodham Walter known as Footpath 16 Woodham Walter in the District of Maldon as described in Part 2 of the Schedule and shown by bold broken lines on the order maps numbered PROW-24-23 rev.15.10.24 and PROW-24-30 rev.04.11.24 contained in this order.

**DIVERSION OF FOOTPATH 16 WOODHAM WALTER
DISTRICT OF MALDON
SECTION 119 HIGHWAYS ACT 1980**

Plan no. PROW-24-23 rev.15.10.24

Key:

Route to Close A-B

New Route A-C-B

Unaffected Route



Definitive Map Sheet TL80NW

Scale 1:500 (A4 paper)

Grid Reference at A 58136,20594

Post Code at A CM9 6RL

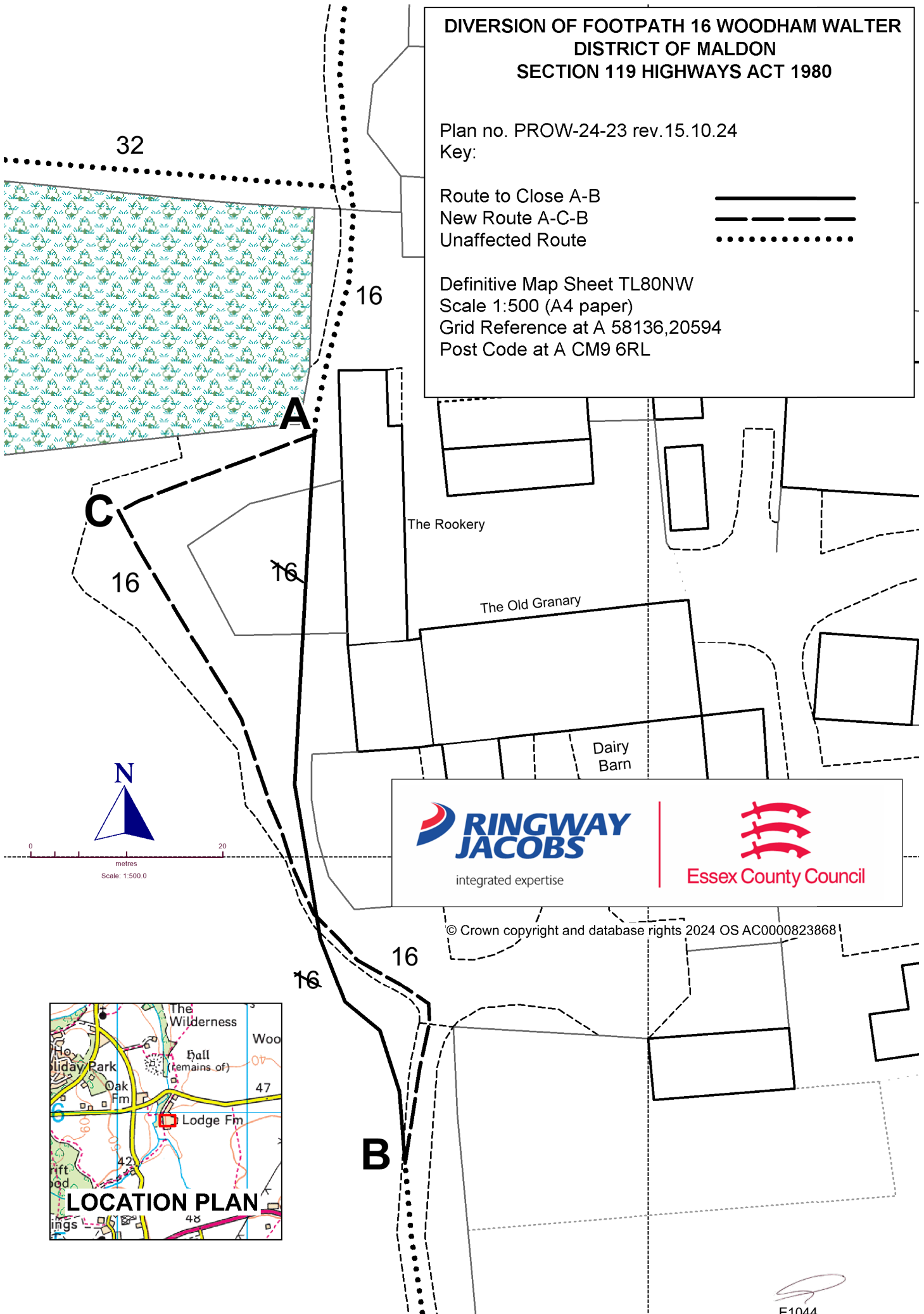

RINGWAY JACOBS
integrated expertise

Essex County Council

© Crown copyright and database rights 2024 OS AC0000823868

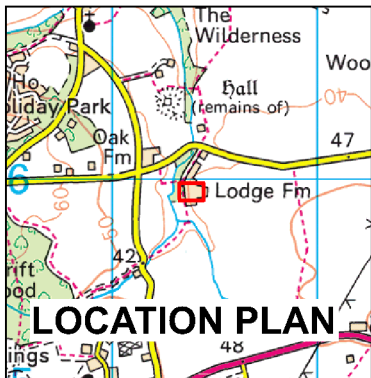

**DIVERSION OF FOOTPATH 16 WOODHAM WALTER
DISTRICT OF MALDON
SECTION 119 HIGHWAYS ACT 1980**

Plan no. PROW-24-30 rev.04.11.24

Key:

Route to Close A-B 
 New Route A-C 
 Unaffected Route 

Definitive Map Sheet TL80NW
 Scale 1:500 (A4 paper)
 Grid Reference at A 58130,20574
 Post Code at A CM9 6RL

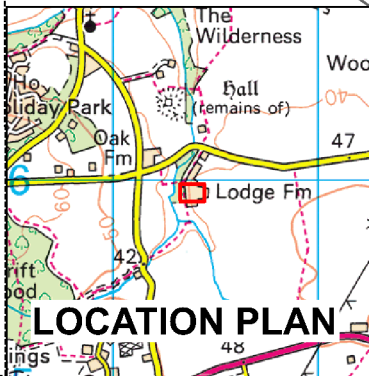
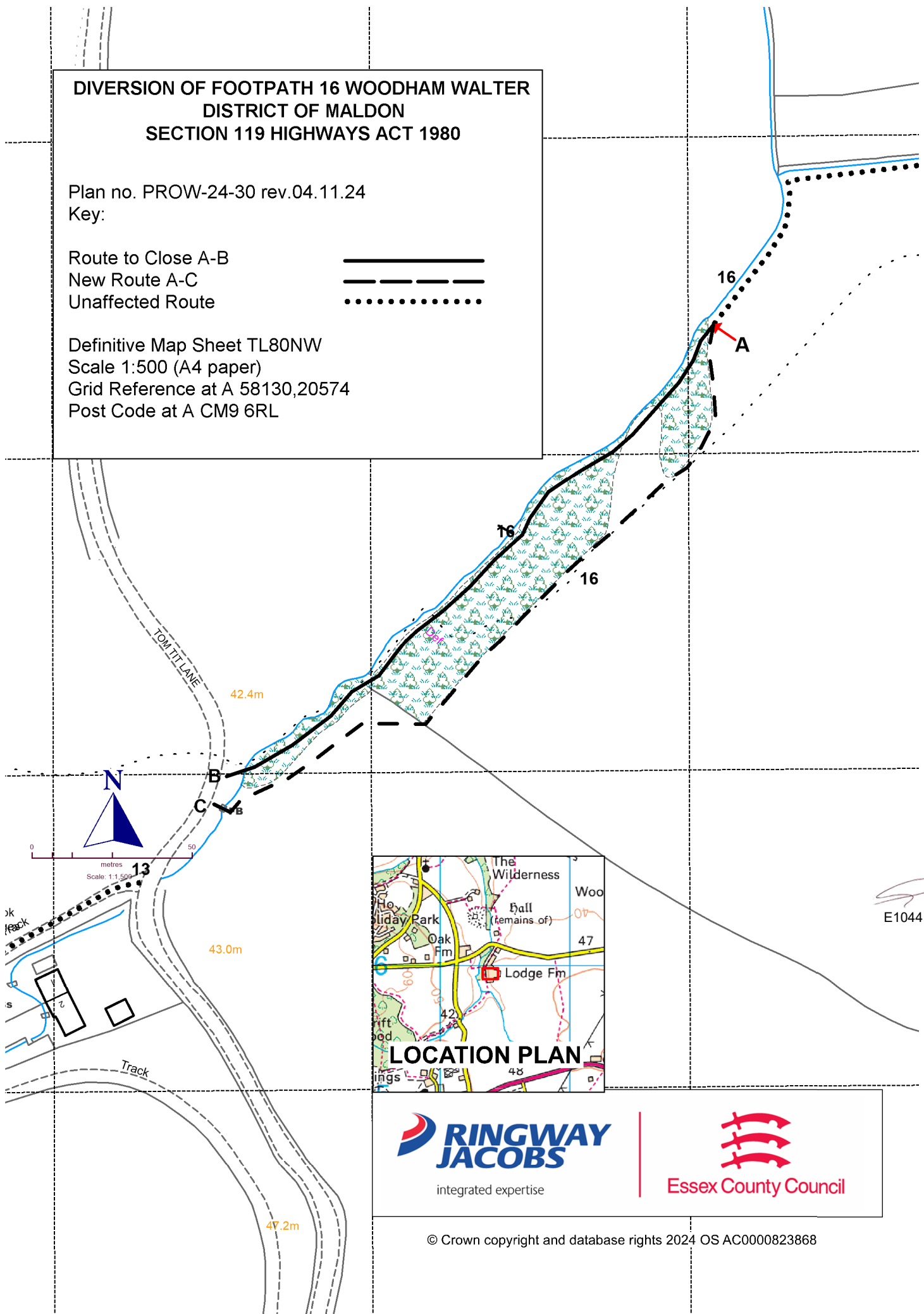

E1044



SCHEDULE

(PART 1)

DESCRIPTION OF SITE OF EXISTING PATH OR WAY

A part length of Footpath 16 Woodham Walter of unknown width shown by a bold continuous line on the order map PROW-24-23 rev.15.10.24 commencing from point **A** at grid reference 58136,20594 at the corner of a farm track running in a generally southerly direction along the track through a patio area and along a grass verge for a total distance of approximately 76 metres to point **B** at grid reference 58137,20586 where it continues unaffected.

A further section of Footpath 16 Woodham Walter of unknown width shown by a bold continuous line on the order map PROW-24-30 rev.04.11.24 commencing from point **A** at grid reference 58130,20574 running in a south westerly direction within a wooded area for a total distance of approximately 212 metres to point **B** at grid reference 58115,20559 where it connects to Tom Tit Lane.

(PART 2)

DESCRIPTION OF SITE OF NEW PATH OR WAY

A footpath being 2 metres in width shown by a bold broken line on the order map PROW-24-23 rev.15.10.24 commencing at the aforementioned point **A** running in a south westerly direction along the farm track for a distance of approximately 21 metres to point **C** at grid reference 58134,20593 where it continues in a south easterly then southerly direction along the farm track for a final distance of approximately 79 metres to the aforementioned point **B** where it continues unaffected.

A further section of footpath being 2 metres in width shown by a bold broken line on the order map PROW-24-30 rev.04.11.24 commencing at the aforementioned point **A** running in first a southerly then generally south westerly direction around the eastern perimeter of the wooded area for a total distance of approximately 233 metres to point **C** at grid reference 58114,20559 located approximately 10 metres south west of the aforementioned point **B** where it connects to Tom Tit Lane.

The COMMON SEAL of ESSEX COUNTY COUNCIL was hereunto affixed on the
twenty seventh day of March 2025.

in the presence of

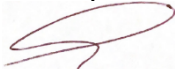

Michelle Nicoll
Attesting Officer

E1044

Dated: 27th March 2025

PUBLIC PATH DIVERSION ORDER

**HIGHWAYS ACT 1980
SECTION 119**

Footpath 16 Woodham Walter
in the District of Maldon

Paul Turner
Director, Legal and Assurance

Seax House
Victoria Road South
Chelmsford
Essex
CM1 1QH