

**EXISTING HIGHWAY ENTITIES
TO BE REMOVED**

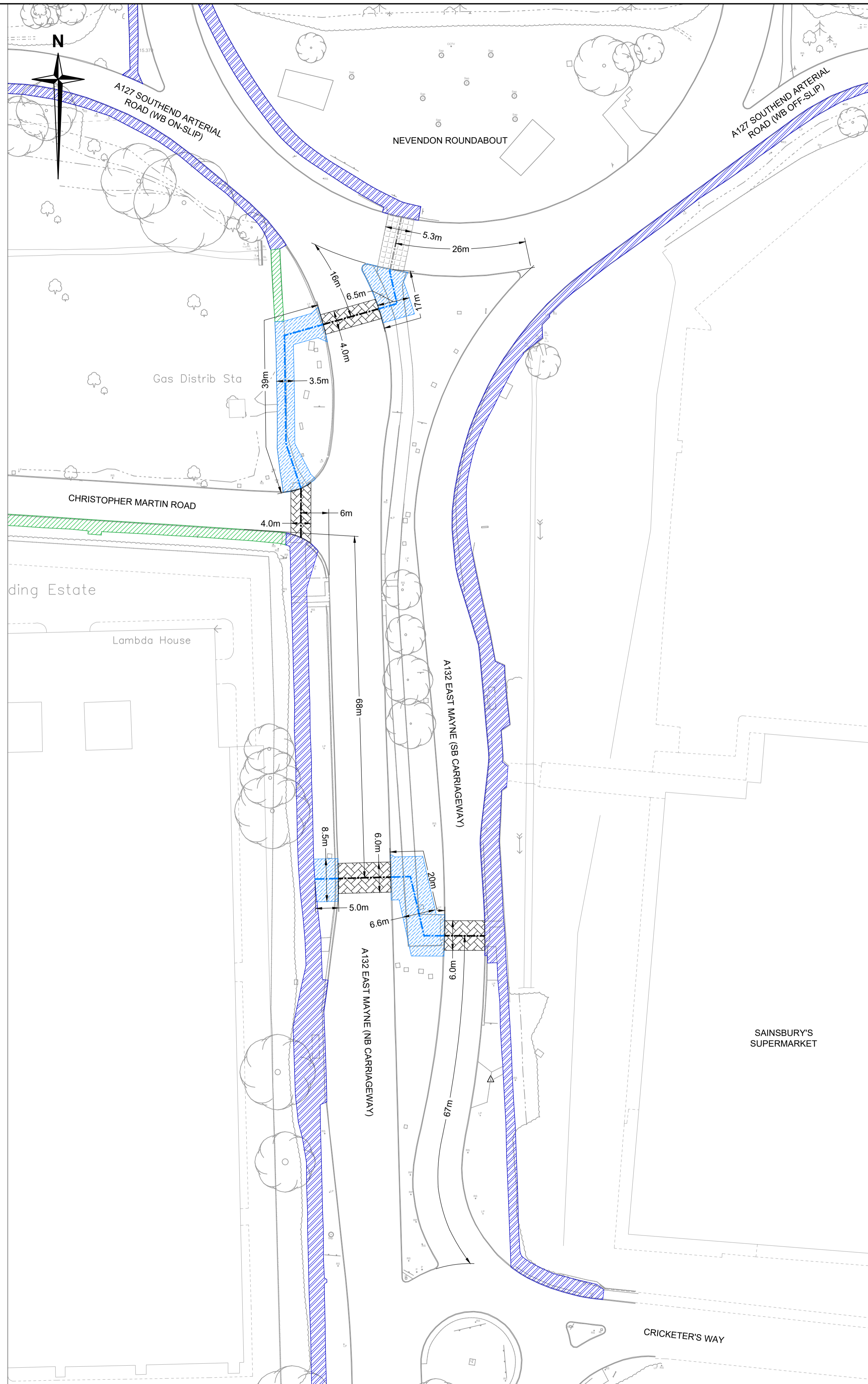

**PROPOSED HIGHWAY ENTITIES
TO BE CONSTRUCTED**

- Notes**
1. Do not scale.
 2. Dimensions shown are approximate.
 3. Longitudinal measurements shown are representative of centre line alignments.
 4. Centre lines shown only for entities requiring legal establishment / removal.

- Key**
- Footways**
- Footway to be removed [S66(4) Highways Act 1980]
 - Footway to remain
- Cycle Tracks**
- Cycle track with right of way on foot to be removed [S65(2) Highways Act 1980]
 - Cycle track with right of way on foot to remain
 - Construction of cycle track with right of way on foot [S65(1) Highways Act 1980]
- Controlled Crossings**
- Controlled crossing to be removed [S23 Road Traffic Regulation Act 1984]
 - Controlled crossing to remain
 - Controlled crossing to be established [S23 Road Traffic Regulation Act 1984]

Rev	Date	Description of revision	Drawn	Checked	Reviewed	Approved

DRAWING STATUS: **PRELIMINARY**



Essex Highways, Seax House, Victoria Road South, Chelmsford, CM1 1QH. Tel: 0345 6037631 © Essex County Council

SCHEME TITLE: **BASILDON AIR QUALITY MANAGEMENT PLAN - EAST MAYNE CROSSINGS**

DRAWING TITLE: **HIGHWAY LEGAL ENTITIES LAYOUT**

DESIGNED	DRAWN	CHECKED	REVIEWED	APPROVED
GCW	GCW	MPA	MPA	CTB
DATE: APR 21	DATE: APR 21	DATE: APR 21	DATE: APR 21	DATE: APR 21

DRAWING UNITS U.N.O.: DIMENSIONS IN METRES LEVELS IN METRES SCALE AT A1 (841X594mm): 1:500

DRAWING No. **B3553-04-00-031** REV. -



This map is reproduced from Ordnance Survey material with the permission of Ordnance Survey on behalf of the Controller of Her Majesty's Stationery Office © Crown Copyright. Unauthorised reproduction infringes Crown Copyright and may lead to prosecution or civil proceedings. Essex County Council, 100019602, 2021
 File Location N:\9 Trans\Info\Major Projects Design\1 Projects\B3553P10_A127 AQMP\03_CAD\04_East Mayne\B3553P10-04-00-031 [W1].dwg Last saved by Gordon.Wyler on 1 April 2021. Printed By Gordon.Wyler on 6 April 2021