

NOTES

1. This drawing has been prepared in accordance with the scope of RPS's appointment with its client and is subject to the terms and conditions of that appointment. RPS accepts no liability for any use of this document other than by its client and only for the purposes for which it was prepared and provided.
2. If received electronically it is the recipients responsibility to print to correct scale. Only written dimensions should be used.
3. This drawing is to be read in conjunction with all relevant scheme drawings.

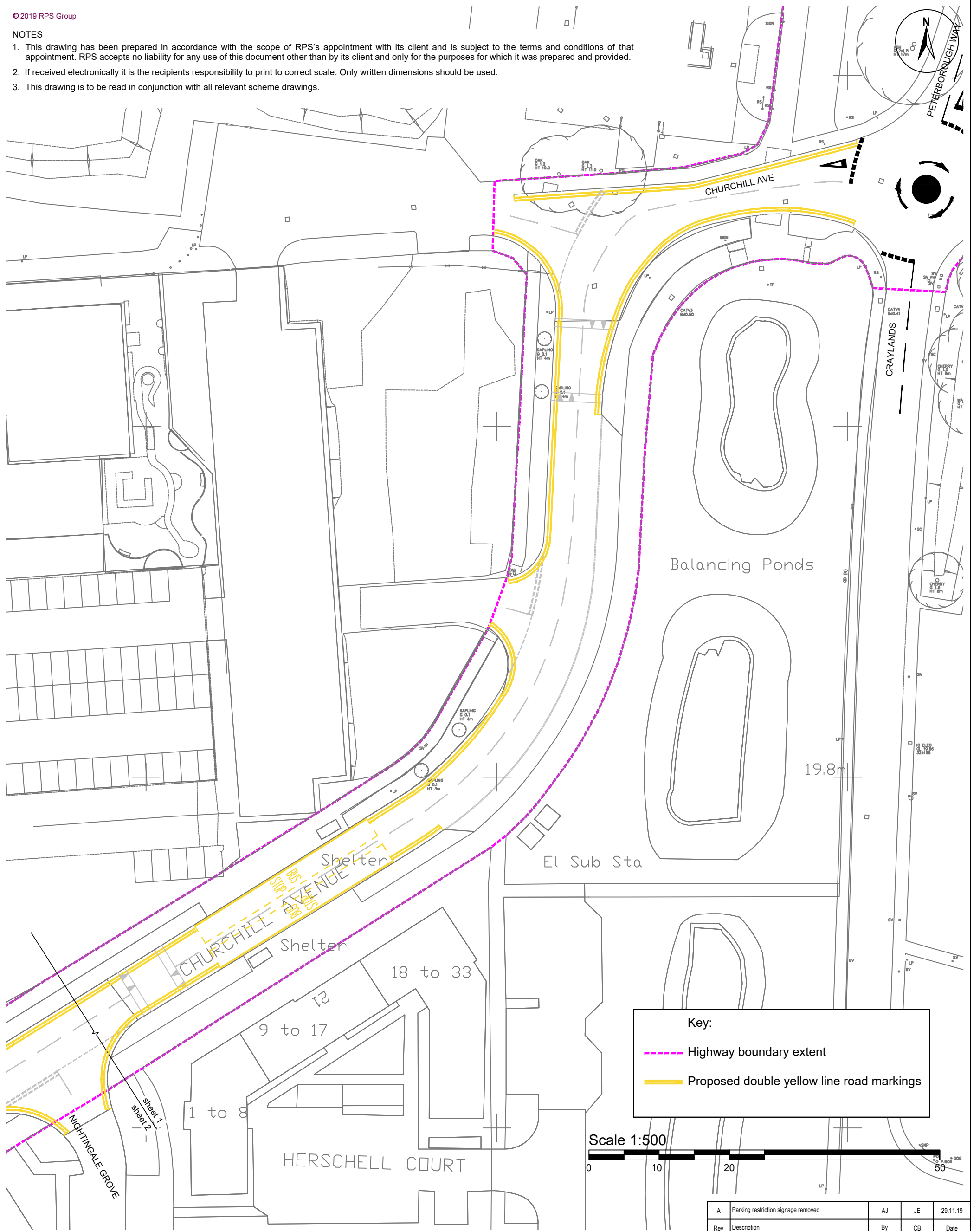

Key:

- Highway boundary extent
- == Proposed double yellow line road markings



| | | | | |
|-----|-------------------------------------|----|----|----------|
| A | Parking restriction signage removed | AJ | JE | 29.11.19 |
| Rev | Description | By | CB | Date |



20 Farringdon Street, London EC4A 4AB
 T: +44(0)20 3691 0500 E: transport@rpsgroup.com

Client Swan Housing Association
 Project Beechwood Village Regeneration
 Title Churchill Avenue Proposed Road Markings and Parking Layout Sheet 1 of 2

Status Drawn By PM/Checked by
INFORMATION AJ JE
 Project Number Scale @ A3 Date Created
 JNY8748 1:500 08.11.19
 RPS Drawing/Figure Number Rev
 JNY8748-D-18 A

rpsgroup.com