

M11 JUNCTION 8 JUNCTION IMPROVEMENTS

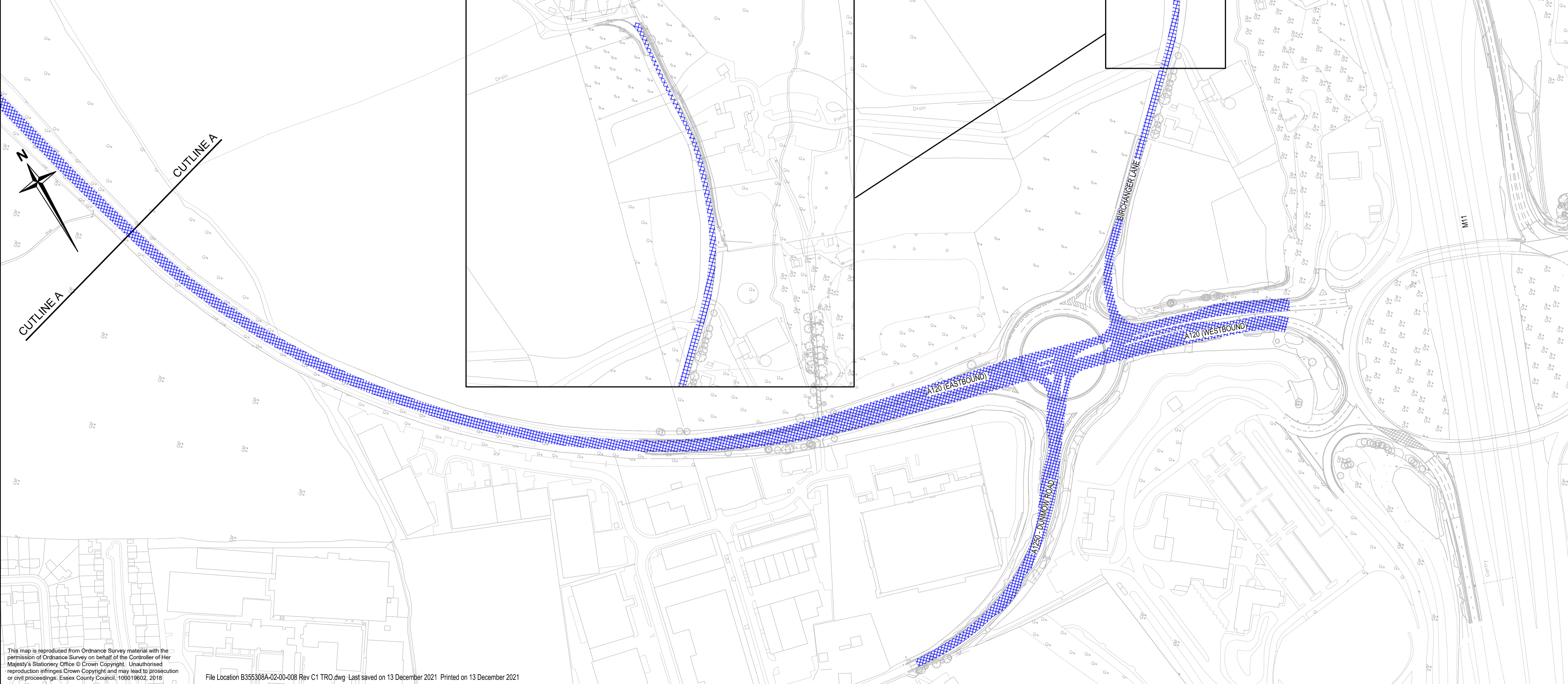

Rev	Date	Description of revision	Drawn	Checked	Reviewed	Approved
C1	12/21	Updated Text	AG	CO'D	TR	TR

DRAWING STATUS: **CONSULTATION**

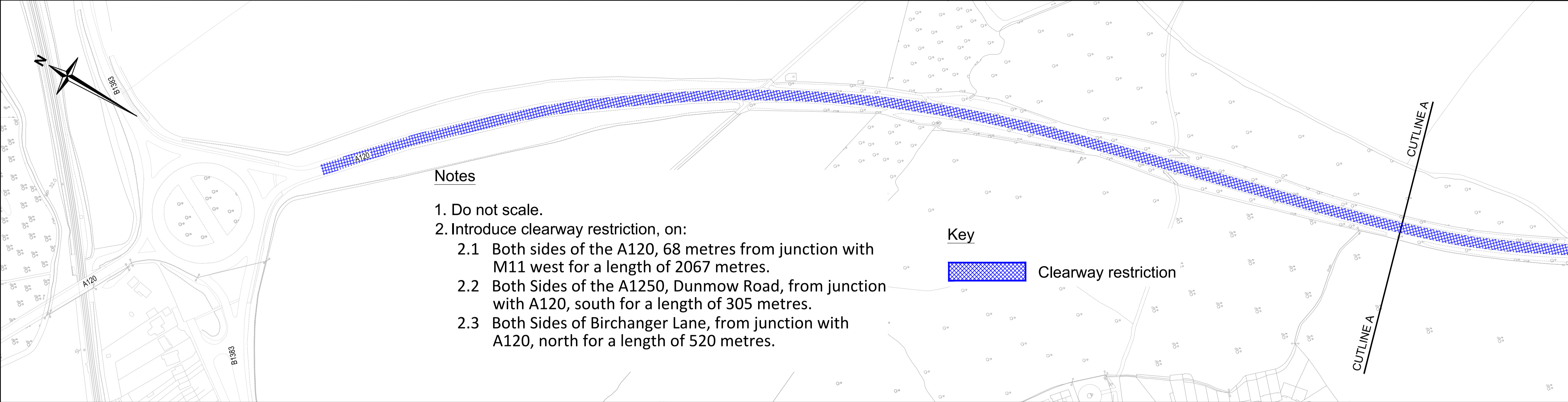

Essex Highways, Seax House, Victoria Road South, Chelmsford, CM1 1QH.
Tel: 0345 6037631 © Essex County Council

SCHEME TITLE: **M11 JUNCTION 8 JUNCTION IMPROVEMENTS**

DRAWING TITLE: **EXTENT OF CLEARWAY A120 SIGNALISED STAGGERED JUNCTION ARRANGEMENT**

DESIGNED	DRAWN	CHECKED	REVIEWED	APPROVED
LM	AG	DS	PM	BS
DATE	DATE	DATE	DATE	DATE
JAN 19	JAN 19	JAN 19	JAN 19	FEB 19

DRAWING UNITS U.N.O. DIMENSIONS IN METRES SCALE AT A1 (841X594mm) 1:2000



DRAWING No. **B355308A-02-00-008** REV. -



This map is reproduced from Ordnance Survey material with the permission of Ordnance Survey on behalf of the Controller of Her Majesty's Stationery Office © Crown Copyright. Unauthorised reproduction infringes Crown Copyright and may lead to prosecution or civil proceedings. Essex County Council, 100019602, 2018
File Location B355308A-02-00-008 Rev C1 TRO.dwg Last saved on 13 December 2021 Printed on 13 December 2021

M11 JUNCTION 8 JUNCTION IMPROVEMENTS

Key

-  50mph speed limit
-  Shared un-segregated footway cycleway
-  Signal-controlled pedestrian/cycle crossing

Notes

1. Do not scale.
2. Introduce 50mph speed restriction, on:
 - 2.1 Both sides of the A120, From a point approximately 68 metres northwest of its junction with the roundabout at Junction 8 of the M11, generally northwest for a distance of approximately 600 metres.
 - 2.2 Both sides of the A1250, From its junction with the A120, southwest for a distance of approximately 295 metres.
 - 2.3 Both sides of Birchanger Lane, From its junction with the A120, generally north for a distance of approximately 515 metres to its junction with Duck End and location of the existing restricted road restriction
3. Introduce shared un-segregated footway cycleway
 - 3.1 A120 north side, From its junction with Birchanger Lane west for a length of 20 metres.
 - 3.2 A120 south side, From its junction with A1250 Dunmow Road, east for a length of 15 metres.
 - 3.3 Birchanger Lane north side, From its junction with A120, north for a distance of approximately 28 metres.
 - 3.4 Birchanger Lane south side, From a point 29 metres north of its junction with the A120, north for a distance of approximately 18 metres.
 - 3.5 A1250-Dunmow Road east side, From its junction with the A120, southwest for a distance of approximately 145 metres.

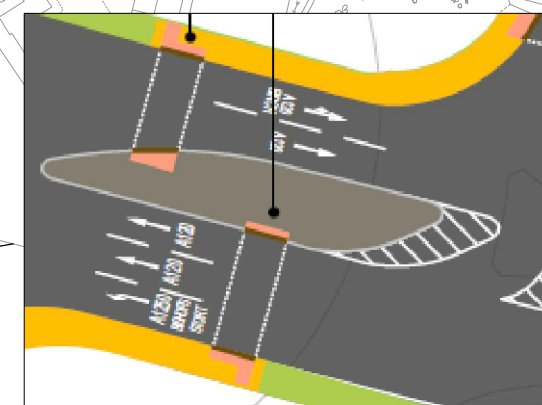
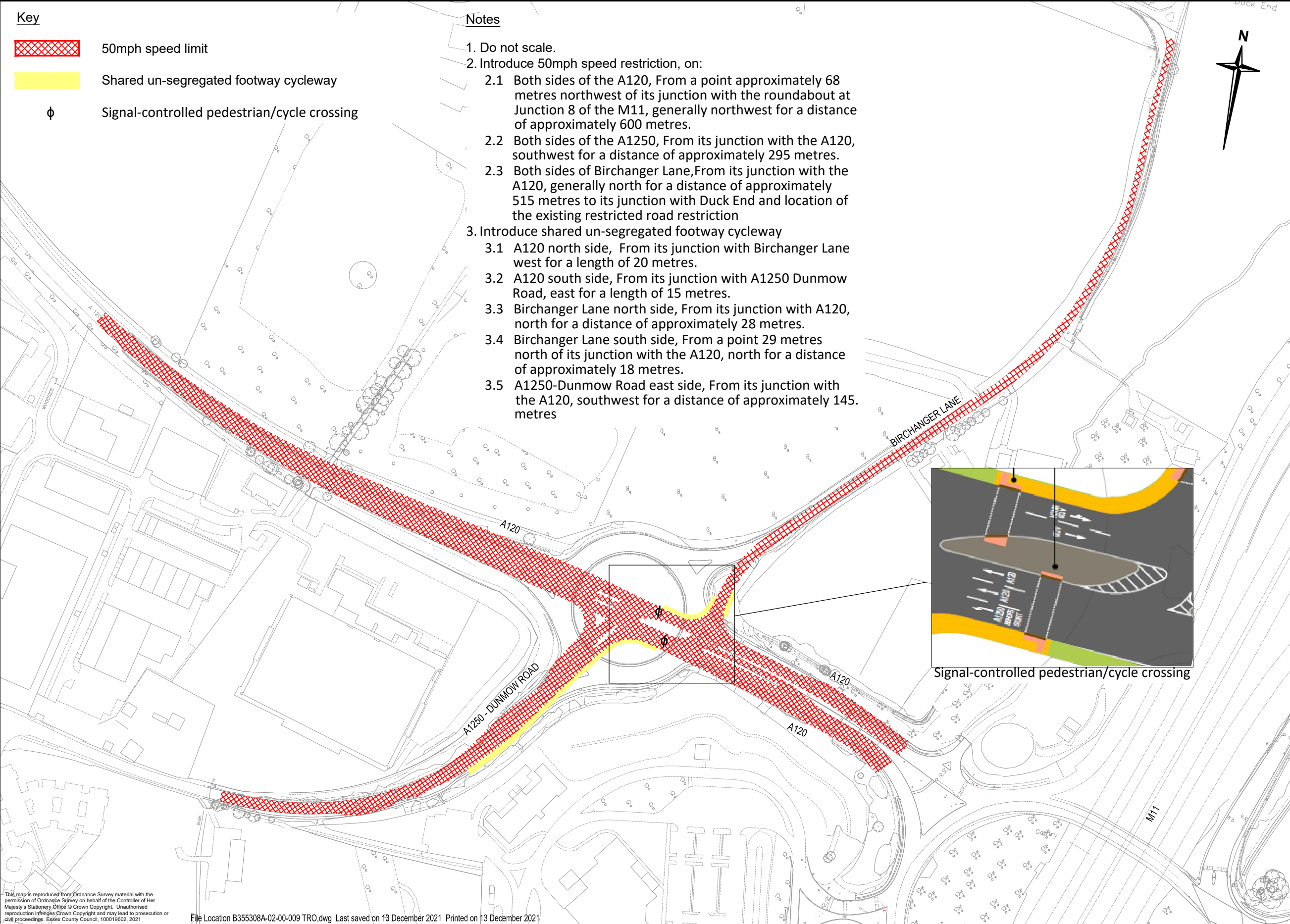

Signal-controlled pedestrian/cycle crossing

Rev.	Date	Description of revision	Drawn	Checked	Review'd	Approved
C1	12/21	Updated Text	AG	COD	TR	TR

DRAWING STATUS: **CONSULTATION**



Essex Highways, Seax House, Victoria Road South, Chelmsford, CM1 1QH. Tel: 0345 6037631 © Essex County Council

SCHEME TITLE: **M11 JUNCTION 8 JUNCTION IMPROVEMENTS**

DRAWING TITLE: **EXTENT OF SPEED LIMIT A120 SIGNALISED STAGGERED JUNCTION ARRANGEMENT**

DESIGNED	DRAWN	CHECKED	REVIEWED	APPROVED
LM	AG	DS	PM	BS
DATE	DATE	DATE	DATE	DATE
JAN 19	JAN 19	JAN 19	JAN 19	FEB 19

DRAWING UNITS U.N.D. DIMENSIONS IN MILLIMETRES LEVELS IN METRES SCALE AT A3 (420x297mm) 1:2500

DRAWING No. **B355308A-02-00-009** REV. **C1**

