

SITE PLAN 1:500

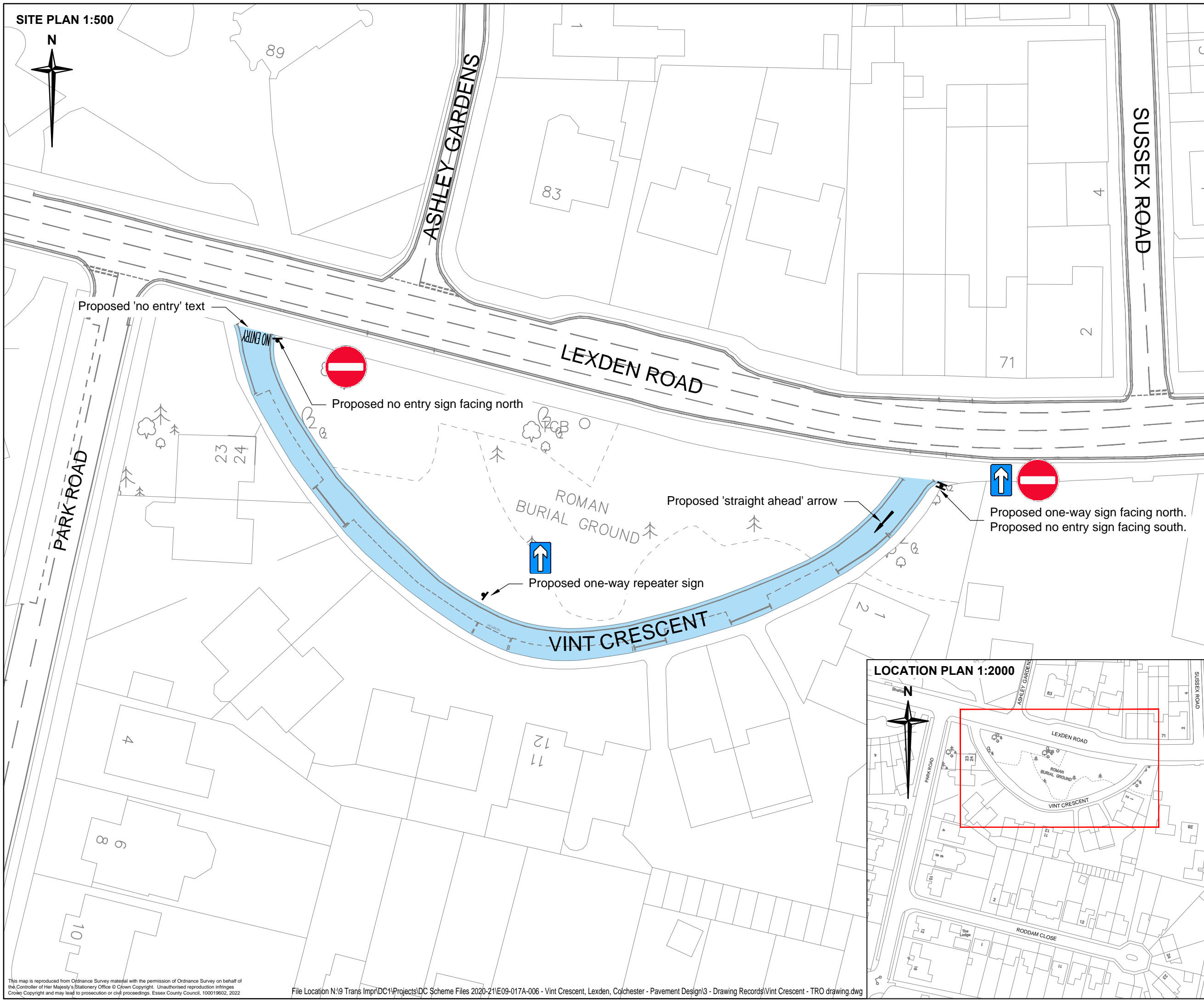

Notes

1. Do not scale.
2. Existing road markings shown in grey.

Key

- Area of interest
- Area subject to one-way order
- Approximate location of proposed sign posts

Rev	Date	Description of revision	Drawn	Checked	Reviewed	Approved
C	19	XXX Description - if needed use two lines and/or 1.5mm text	XXX	XXX	XXX	XXX
B	19	XXX Description - if needed use two lines and/or 1.5mm text	XXX	XXX	XXX	XXX
A	19	XXX Description - if needed use two lines and/or 1.5mm text	XXX	XXX	XXX	XXX

DRAWING STATUS

**FOR CONSULTATION**



Essex Highways, Seax House, Victoria Road South, Chelmsford, CM1 1QH.  
Tel: 0345 6037631 © Essex County Council

SCHEME TITLE  
**E09-017A-006  
VINT CRESCENT  
LEXDEN, COLCHESTER**

DRAWING TITLE  
**ONE-WAY TRAFFIC  
REGULATION ORDER**

DESIGNED	DRAWN	CHECKED	REVIEWED	APPROVED
KJ	KJ	SW	KJ	SW
DATE	DATE	DATE	DATE	DATE
MAR 22	MAR 22	MAR 22	MAR 22	MAR 22
DRAWING UNITS U.N.O. DIMENSIONS IN MILLIMETRES				SCALE AT A3 (620x297mm) AS SHOWN
LEVELS IN METRES				

DRAWING No: **E09-017A-006-12-001** REV: -

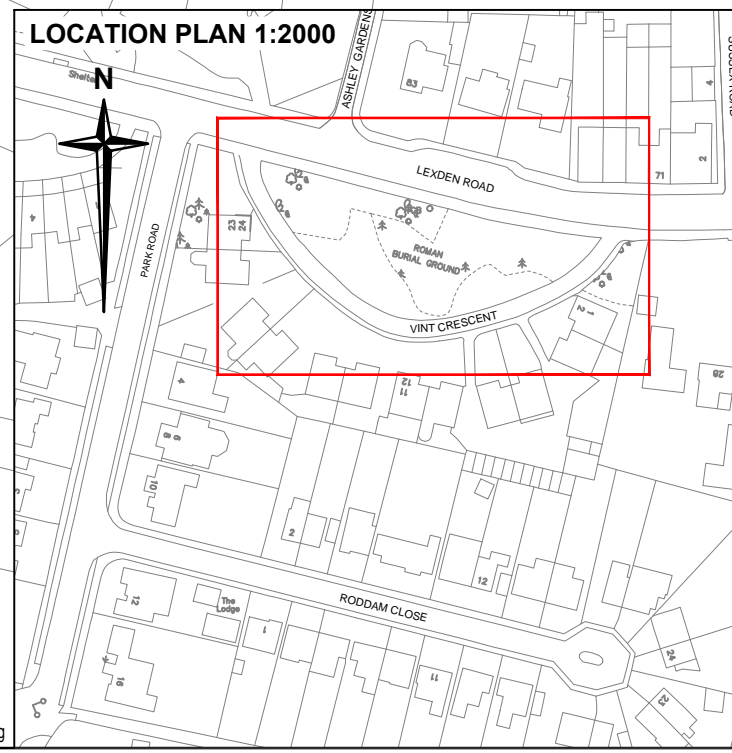

This map is reproduced from Ordnance Survey material with the permission of Ordnance Survey on behalf of the Controller of Her Majesty's Stationery Office © Crown Copyright. Unauthorised reproduction infringes Crown Copyright and may lead to prosecution or civil proceedings. Essex County Council, 100019602, 2022