

- Notes**
- Do not scale.
  - For retained elements of the National Highways proposals, the alignment has been sourced and displayed for illustrative purposes only. For further details please see official National Highways authored documentation.
- Key**
- Existing/proposed kerb
  - Existing/proposed carriageway
  - Proposed carriageway with red pigment
  - Proposed road marking
  - Existing/proposed paved traffic island
  - Proposed active travel corridor
  - Proposed unbound granular bridleway
  - Existing/proposed shared use footway/cycleway
  - Existing/proposed footway
  - Existing/proposed controlled crossing
  - Existing/proposed uncontrolled crossing
  - Existing Public Right of Way
  - Existing/proposed verge or planting

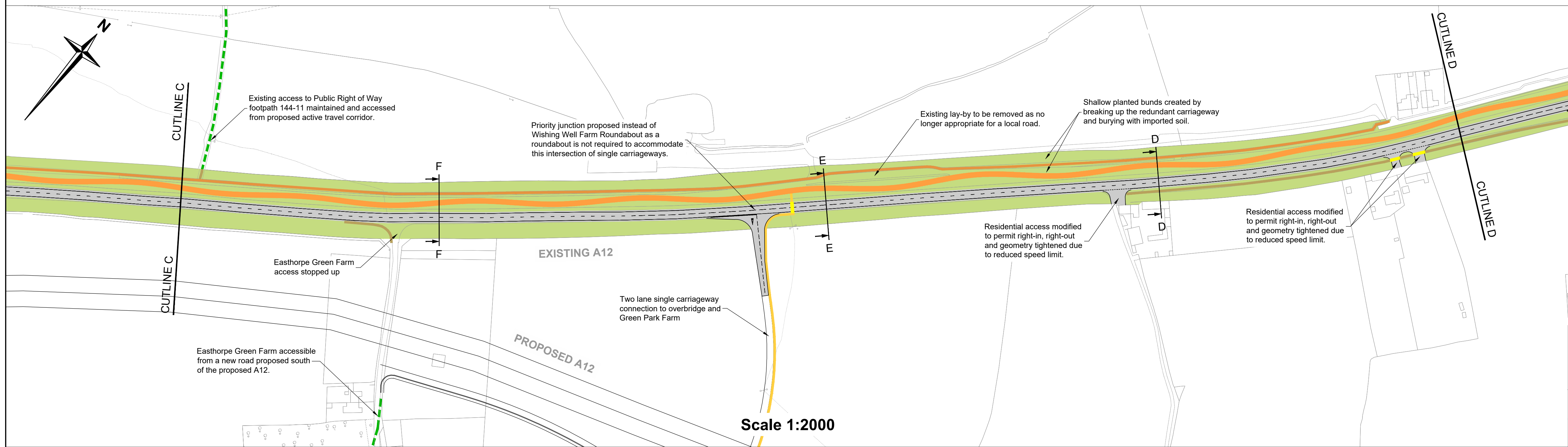

Rev.	Date	Description of revision	Drawn	Checked	Review'd	Approv'd

DRAWING STATUS  
**FOR INFORMATION**



Essex Highways, Seax House, Victoria Road South, Chelmsford, CM1 1QH.  
Tel: 0345 6037631 © Essex County Council

SCHEME TITLE  
**A12 DCO DETRUNKING OPTIONS**

DRAWING TITLE  
**FEERING TO MARKS TEY ECC PROPOSALS SHEET 2 OF 3**

DESIGNED	DRAWN	CHECKED	REVIEWED	APPROVED
BA	OS/BA	IJ	MS	KC
DATE JAN 23	DATE JAN 23	DATE JAN 23	DATE JAN 23	DATE JAN 23

DRAWING UNITS U.N.O. DIMENSIONS IN MILLIMETRES LEVELS IN METRES SCALE AT A1 (841X594mm) AS SHOWN

DRAWING NO. **B3553RB1-02-00-004** REV. -

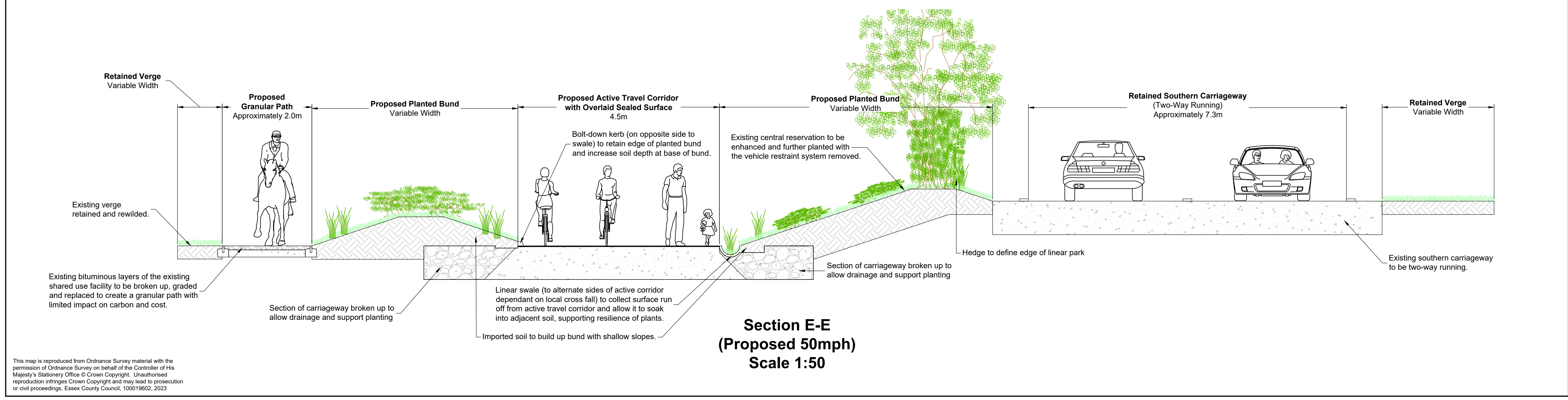

This map is reproduced from Ordnance Survey material with the permission of Ordnance Survey on behalf of the Controller of His Majesty's Stationery Office © Crown Copyright. Unauthorised reproduction infringes Crown Copyright and may lead to prosecution or civil proceedings. Essex County Council, 100019602, 2023

